

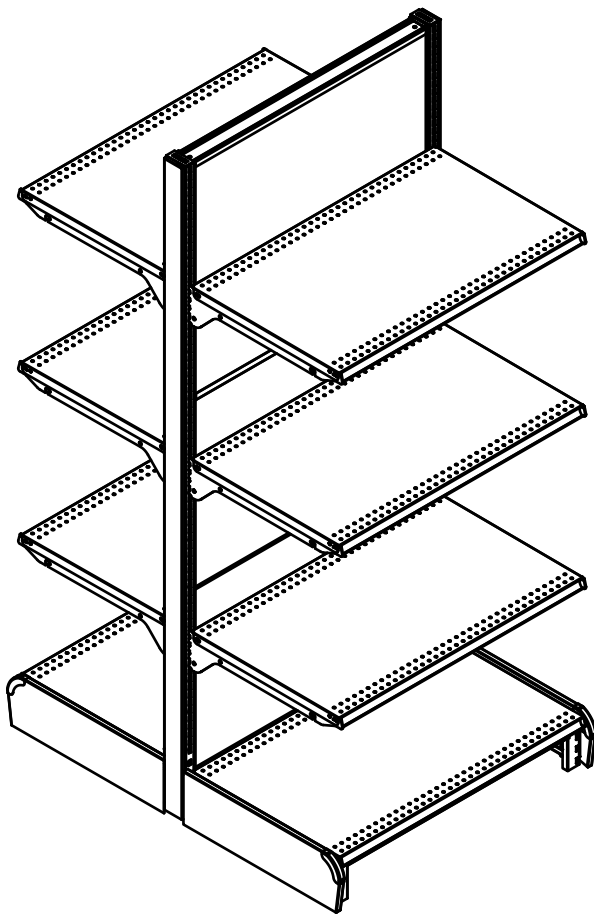

S-SERIES SHELVING INSTALLATION MANUAL

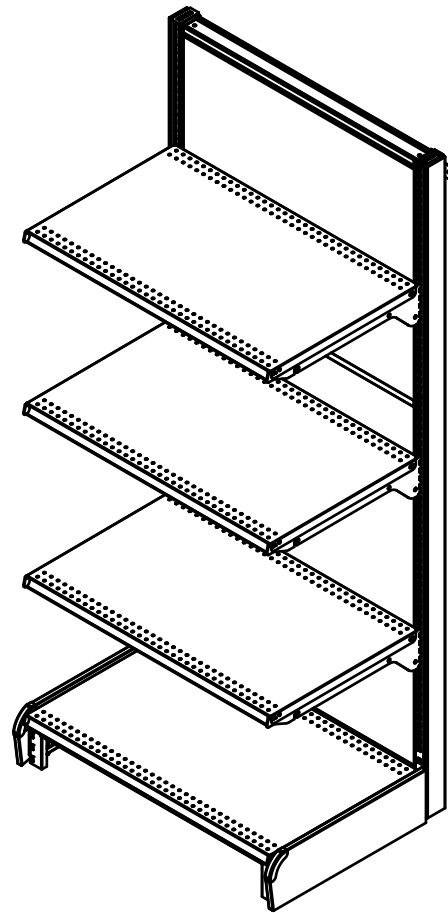

GONDOLA



WALL UNIT



Midwest Retail Services, Inc.

800-576-7577

www.midwestretailservices.com

COMPONENTS



ITEM #1
UPRIGHT END
COVER



ITEM #2
SS HD POST
(UPRIGHT)

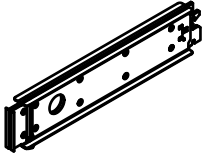

ITEM #5
BASE SHOE

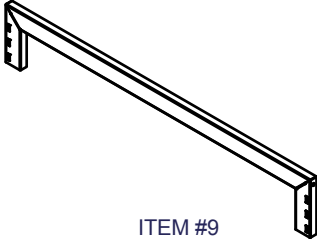

ITEM #9
OPEN KICK PLATE

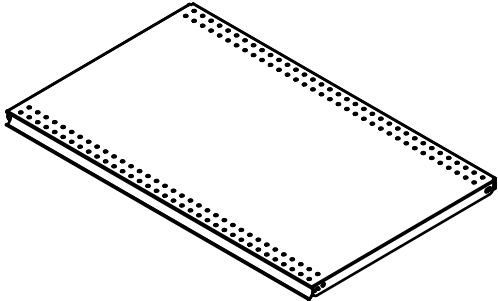

ITEM #6
UPPER SHELF

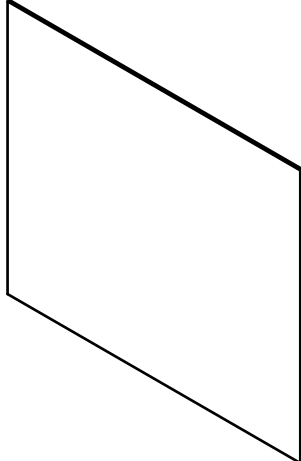

ITEM #10
MASONITE BACK
PLAIN/PERFORATED

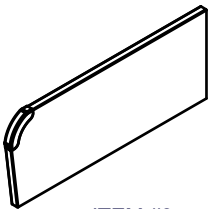

ITEM #3
LEFT SHOE
COVER

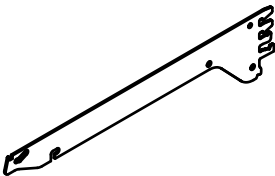

ITEM #7
BRACKET

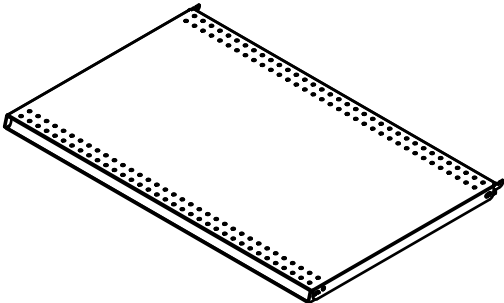

ITEM #8
BASE SHELF

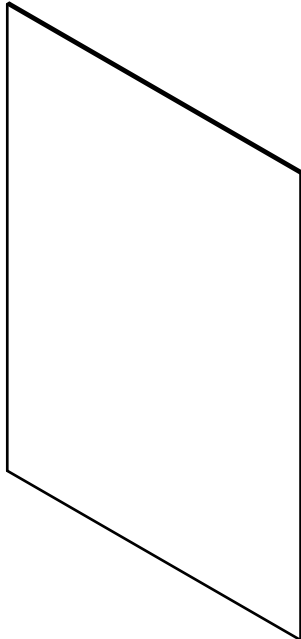

ITEM #11
MASONITE BACK
PLAIN/PERFORATED

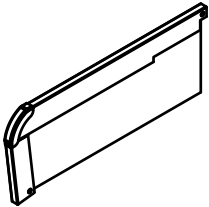

ITEM #4
RIGHT SHOE
COVER

COMPONENTS



ITEM #12
TOP CROSS-BAR

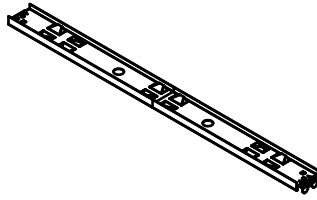

ITEM #13
CENTER CROSS-BAR

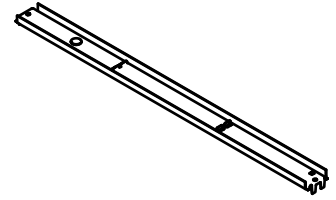

ITEM #14
BOTTOM CROSS-BAR

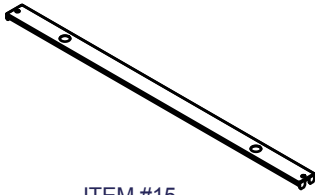

ITEM #15
INTERMEDIATE CROSS-BAR

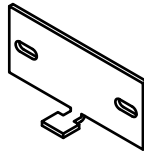

ITEM #16
WALL ANCHOR BRACKET

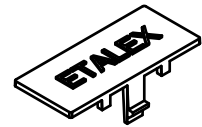

ITEM #17
PLASTIC CAP

TOOLS



DRILL



LEVEL



RUBBER Mallet

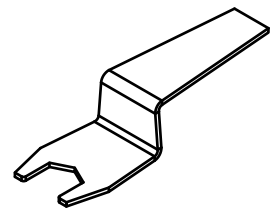

LEVELER KEY

EXPLODED VIEW

S-SERIES WALL UNIT

PART LIST		
ITEM	QTY	DESCRIPTION
1	2	UPRIGHT END COVER
2	2	SS HD POST (UPRIGHT)
3	1	LEFT SHOE COVER
4	1	RIGHT SHOE COVER
5	2	BASE SHOE SS-LB
6	3	UPPER SHELF
7	6	BRACKET
8	1	BASE SHELF
9	1	OPEN KICK PLATE
10	1	MASONITE BACK PLAIN/ PERFORATED
11	1	MASONITE BACK PLAIN/ PERFORATED
12	1	TOP CROSS-BAR
13	1	CENTER CROSS-BAR
14	1	BOTTOM CROSS-BAR
15	1	INTERMEDIATE CROSS-BAR
16	2	WALL ANCHOR BRAQUET

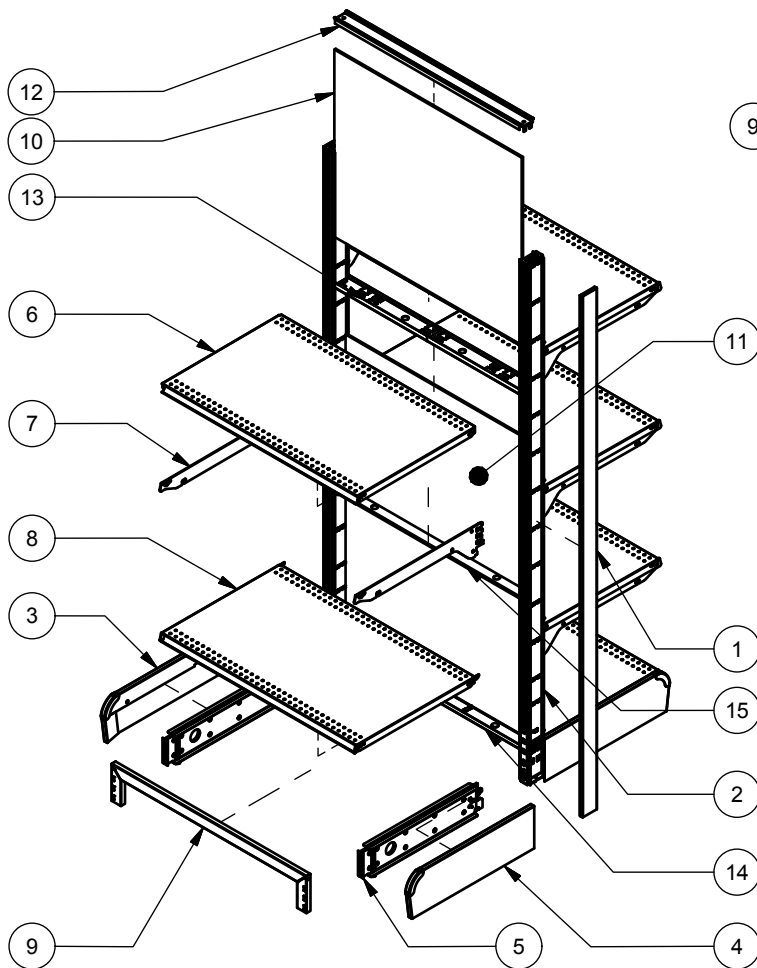
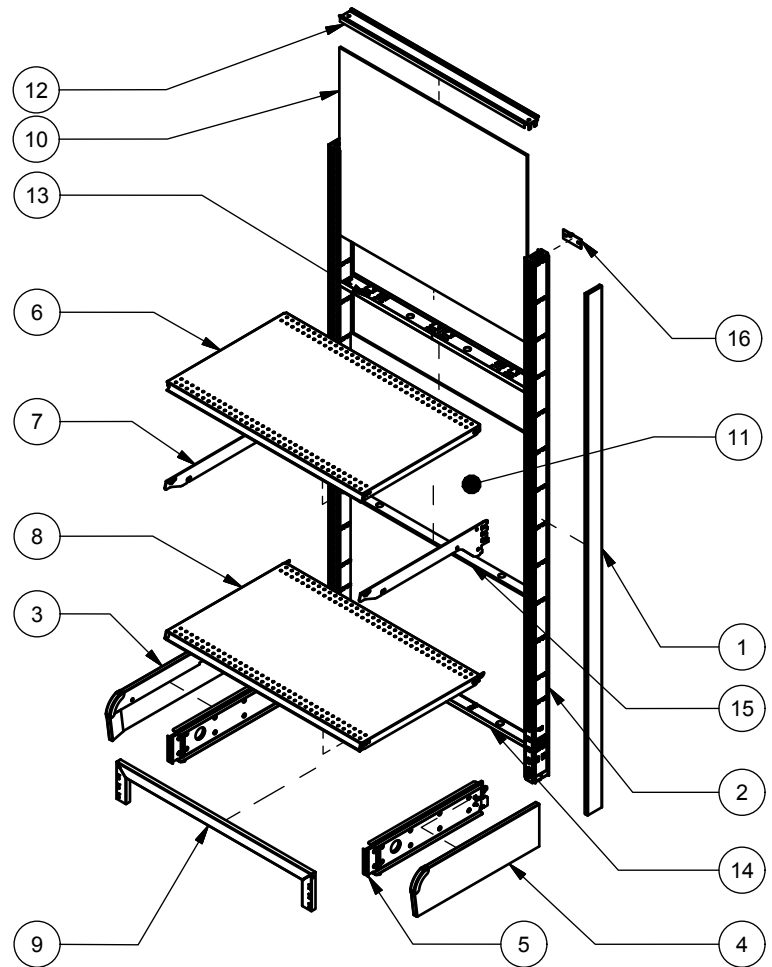

S-SERIES ISLAND

PART LIST		
ITEM	QTY	DESCRIPTION
1	2	UPRIGHT END COVER
2	2	SS HD POST (UPRIGHT)
3	2	LEFT SHOE COVER
4	2	RIGHT SHOE COVER
5	4	BASE SHOE SS-LB
6	6	UPPER SHELF
7	12	BRACKET
8	2	BASE SHELF
9	1	OPEN KICK PLATE
10	2	MASONITE BACK PLAIN/PERF
11	2	MASONITE BACK PLAIN/PERF
12	1	TOP CROSS-BAR
13	1	CENTER CROSS-BAR
14	1	BOTTOM CROSS-BAR
15	1	INTERMEDIATE CROSS-BAR

STEP 1

TRACE A CHALK LINE ON THE FLOOR FOR DESIRED LOCATION OF GONDOLA AND LAY DOWN THE FEET (ITEM#1), POSTS (UPRIGHT) (ITEM#2), OPEN KICK PLATE (ITEM#9) AND THE CROSS-BARS (ITEM#10-11-13) ALONG THE CHALK LINE.

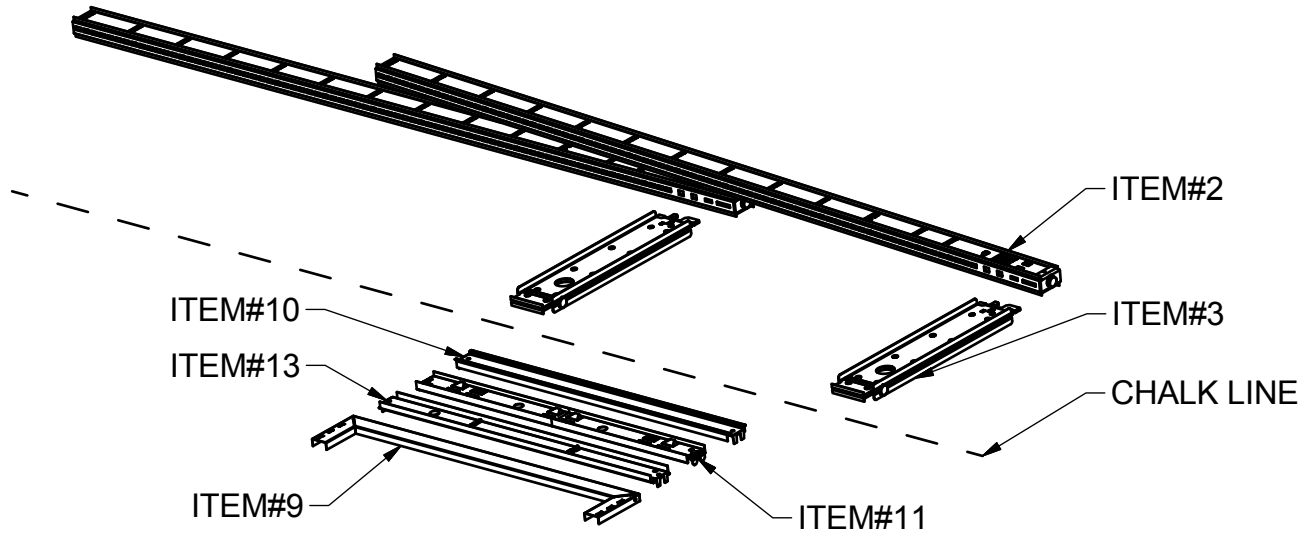

STEP 2

INSTALL THE BASE SHOE AT THE BOTTOM OF THE POST (UPRIGHT). INSERT THE TEETH INTO THE SLOTS AND GIVE A PRESSURE BY PUSHING DOWN THE SHOE UNTIL THE LOCK AND THE LATCH ARE ENGAGED.

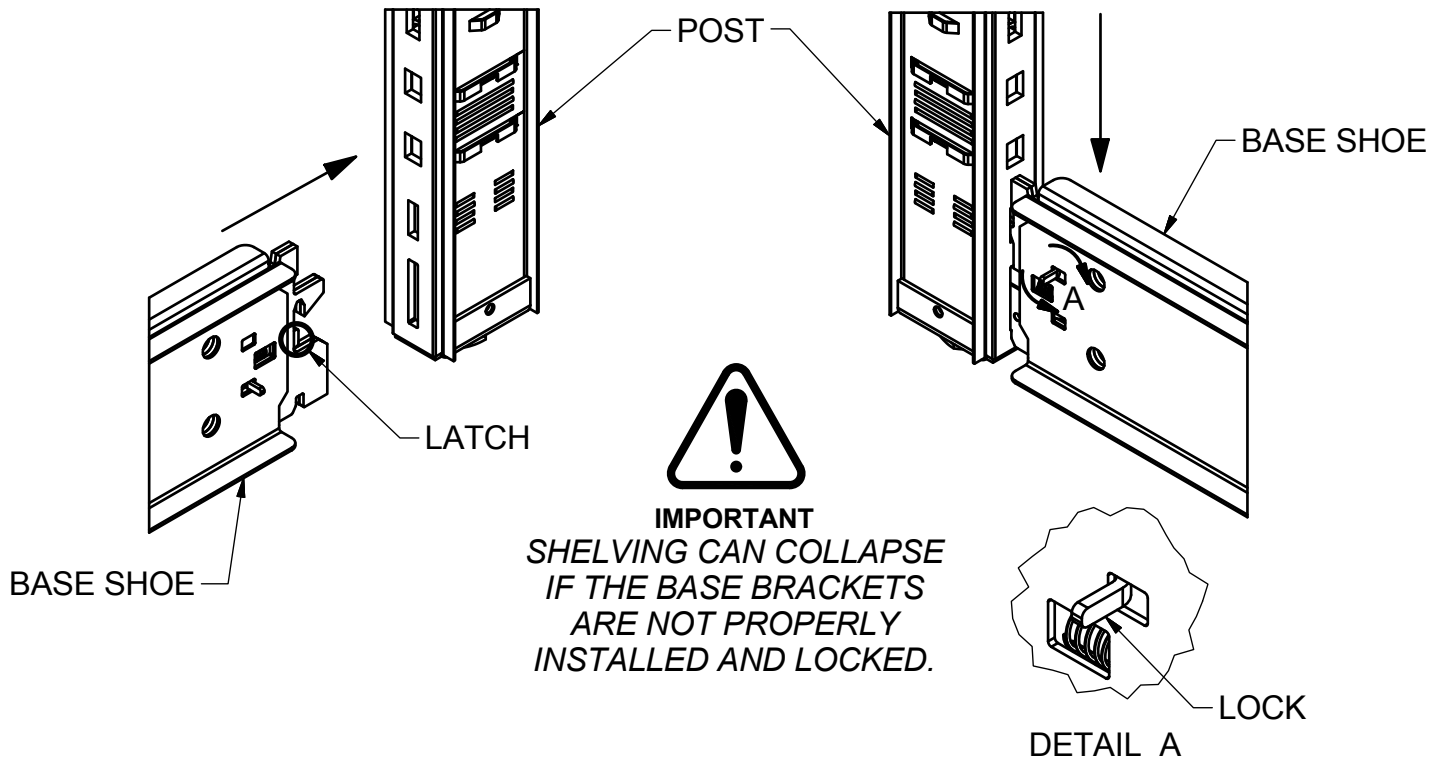

INFORMATION FOR ANCHOR

ONLY REQUIRE FOR THE WALL UNIT

INSTALL THE WALL ANCHOR BRACKET (ITEM#15) ON THE WALL AT THE TOP OF EACH POST (UPRIGHT). INSERT THE TOOTH OF THE ANCHOR IN THE FIRST SLOTS FROM THE BACK BY TURNING IN THE POSITION UPRIGHT. AS SOON THE TOOTH IS IN PLACE, PUT IT BACK ON THE HORIZONTAL POSITION AND FIX IT WITH THE WOOD SCREW NO 8 X 1 1/2" L X 2.

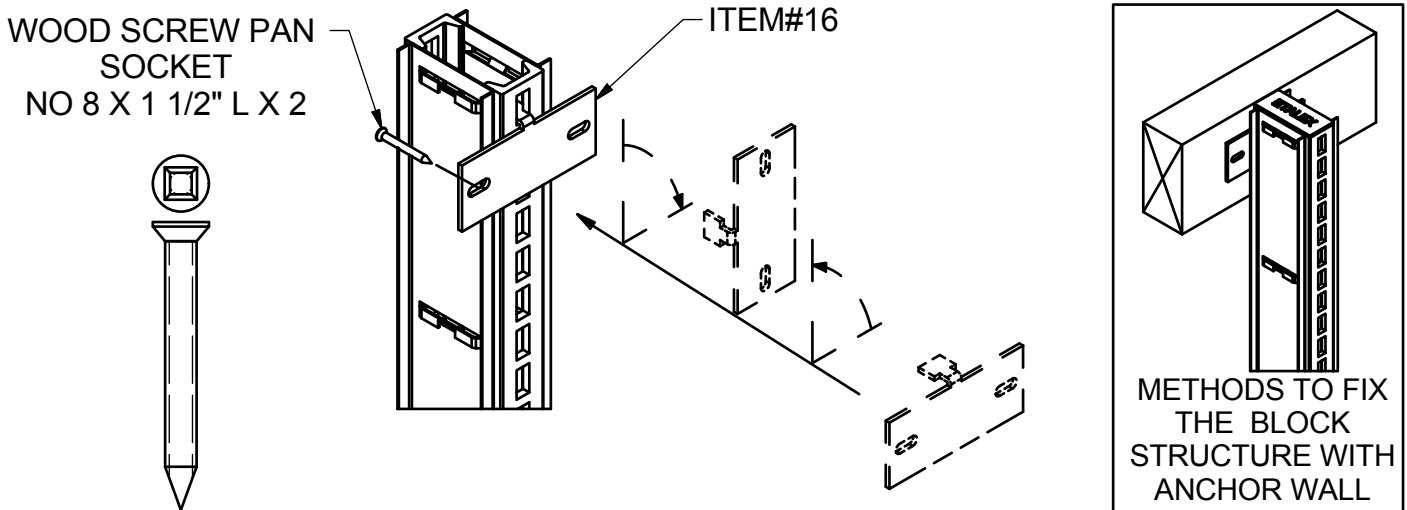

OTHER OPTION: THE WALL ANCHOR BAR FOR EACH WALL SECTION.

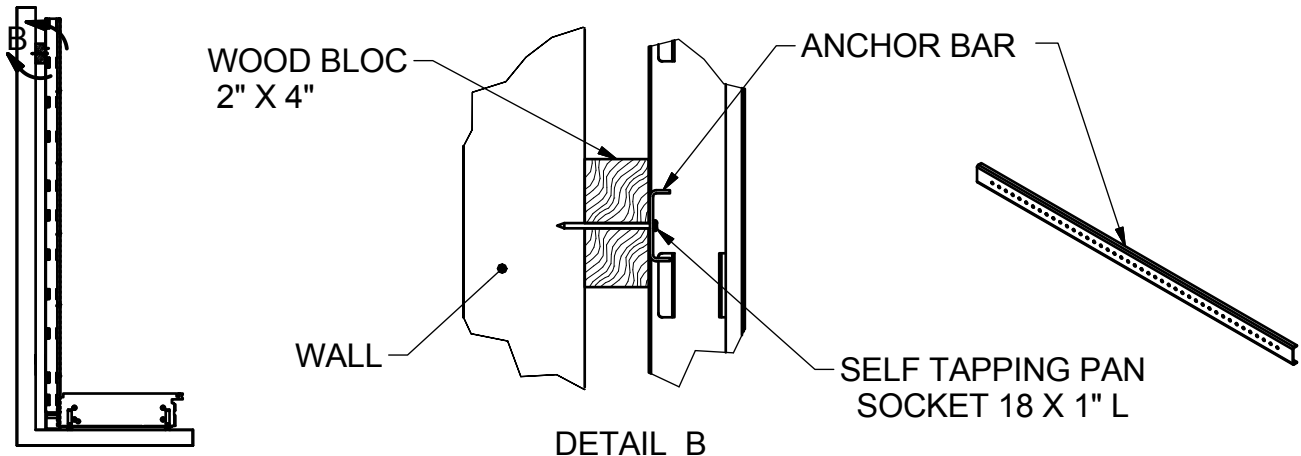

METHODS TO FIX THE BLOCK WALL

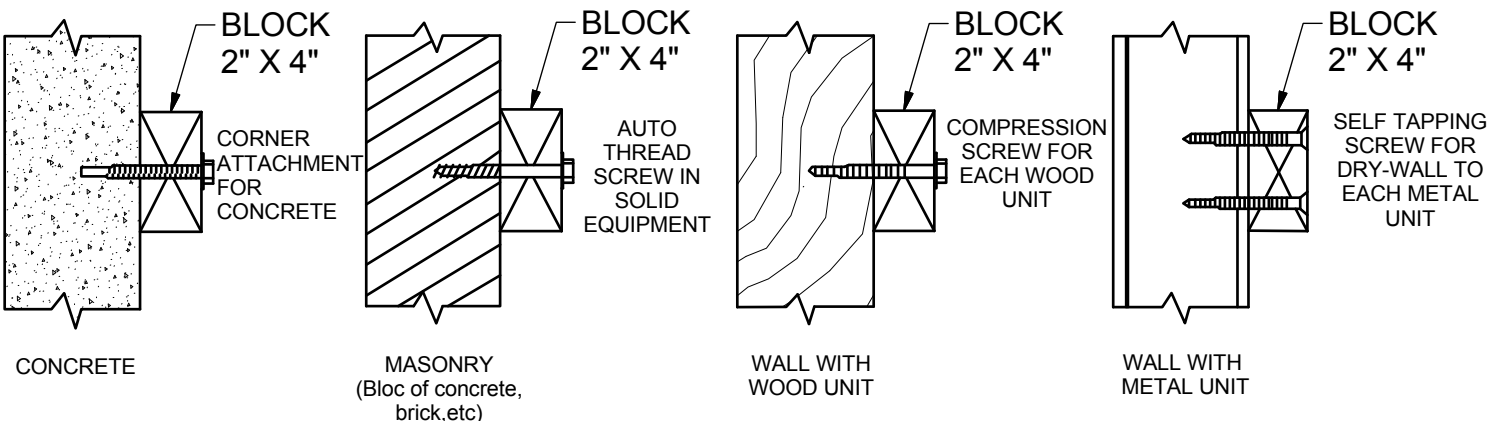

STEP 3

ADJUST THE BASE FOOT LEVELING SCREW AT 3/4" AND THE UPRIGHT POST LEVELING SCREW AT 1/2".

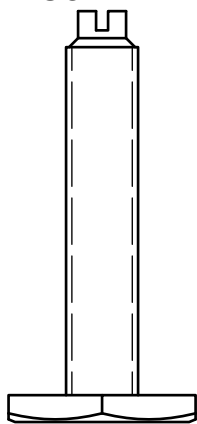

IMPORTANT

THE GONDOLA MUST BE LEVELED AND CORRECTLY ADJUSTED. FAILURE CAN DO SO MANY CAUSE : SHELVING COLLAPSE AND PERSONAL INJURY.

NOTE

ENGINEERING MAY SUGGEST THE USE OF THE ANCHOR FOOT BRACKETS SECURED WITH ANCHORS BOLT 1/4" X 2 1/4"L FOR EACH POST, INTO THE FLOOR.

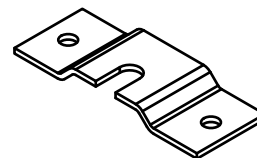

STEP 4

INSTALL THE MASONITE BACKS AND THE CROSS-BARS:

1- INSERT THE TEETH OF THE BOTTOM CROSS-BAR INTO THE LOWER POSITION OF THE UPRIGHT SLOTS.

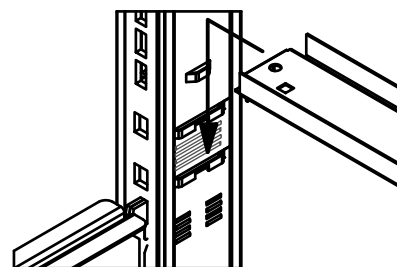

2-SLIDE IN THE MASONITE BACK 47 5/8" H AND INSTALL THE INTERMEDIATE CROSS-BAR IN THE MIDDLE REAR OF THE BACK.

3- INSTALL THE CENTER CROSS-BAR FOR SLIDING IN THE LAST MASONITE BACK 29 7/8" H AND PLACE THE TOP CROSS-BAR .

SEE THE GRID OF THE MASONITE CHART (PAGE 20).

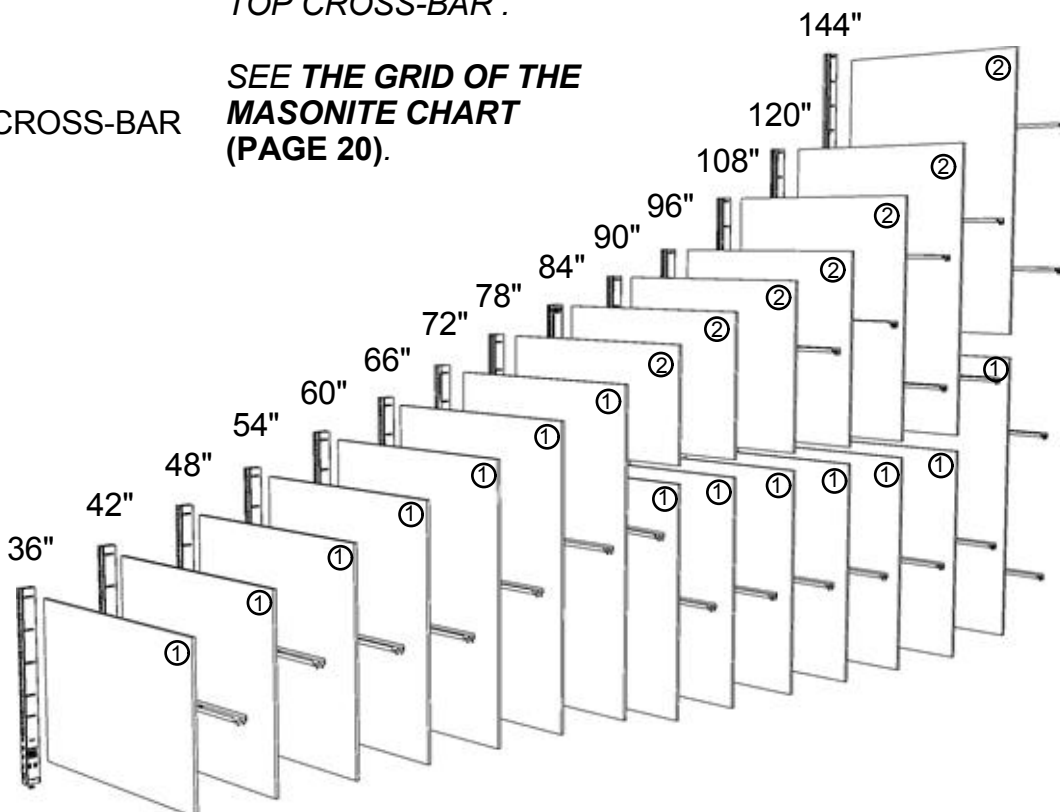
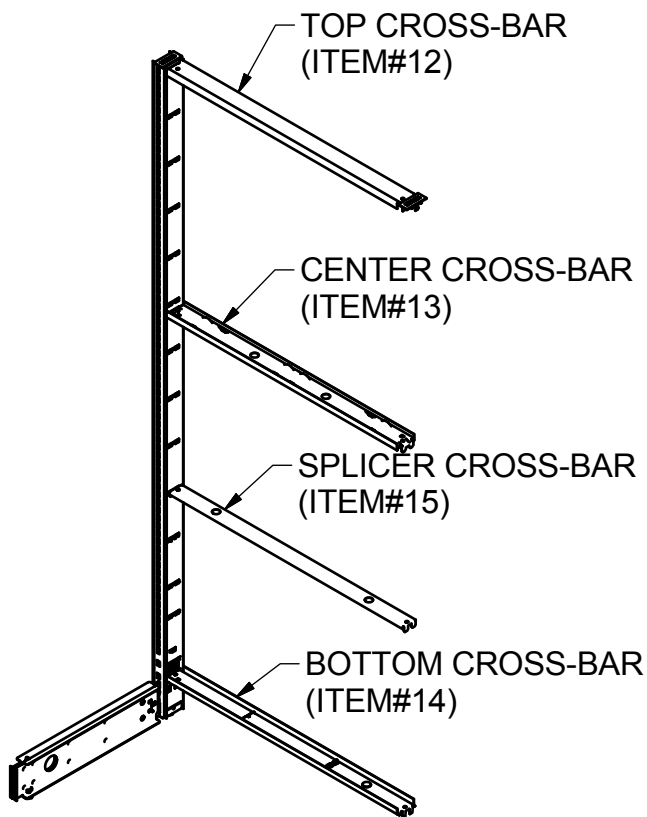

NOTE

WARNING! USE WITH CARE IN LOWERING BACK INTO PLACE. DO NOT DROP!

STEP 5

INSTALL THE OPEN KICK PLATE (ITEM#9) IN THE FRONT OF THE BASE SHOES TO STABILIZE THE UNIT BY SLIDING THE FRONT FRAME FROM THE TOP INTO THE BRACKETS.

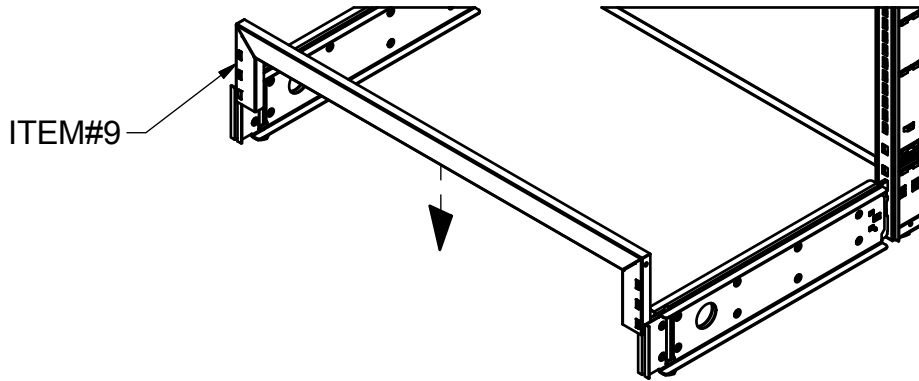

STEP 6

LEVEL THE UNIT HORIZONTALLY, BY ADJUSTING THE LEVELERS IN THE FRONT AND IN THE BACK OF THE FEET TO ENSURE THE STRUCTURES ARE LEVELED AND PLUMB.

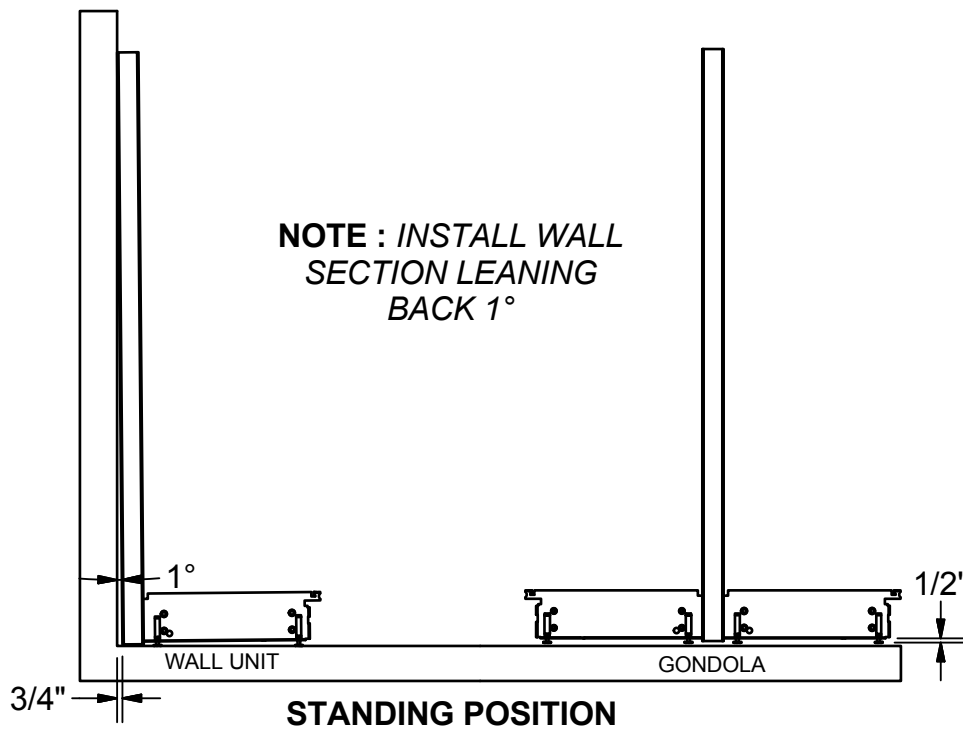

STEP 7

INSTALL THE BASE SHELF (ITEM#8) BY INSERTING THE BRACKETS INTO THE BOTTOM SLOTS OF THE POST (UPRIGHT).

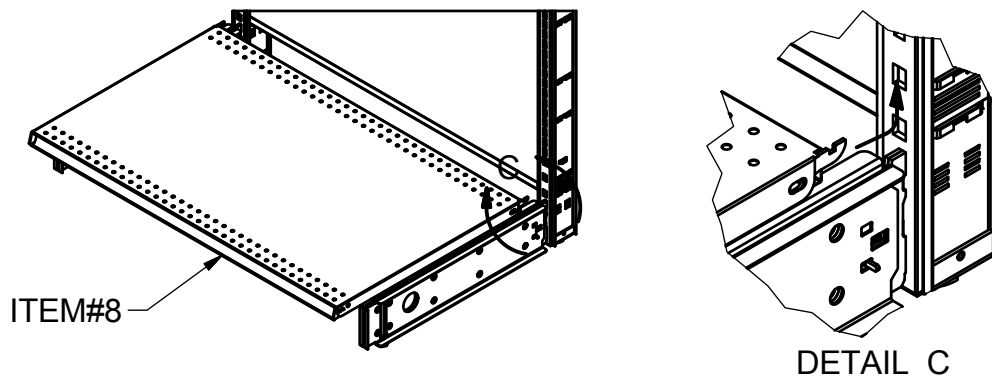

STEP 8

INSTALL THE UPRIGHT END COVER (ITEM#1) ON BOTH UPRIGHT ENDS, SLIDE THE SHOE COVERS (ITEM#4-5) ON TO THE BASES SHOES AND INSERT THE PLASTIC CAP (ITEM#17) ON THE TOP OF EACH POST (UPRIGHT).

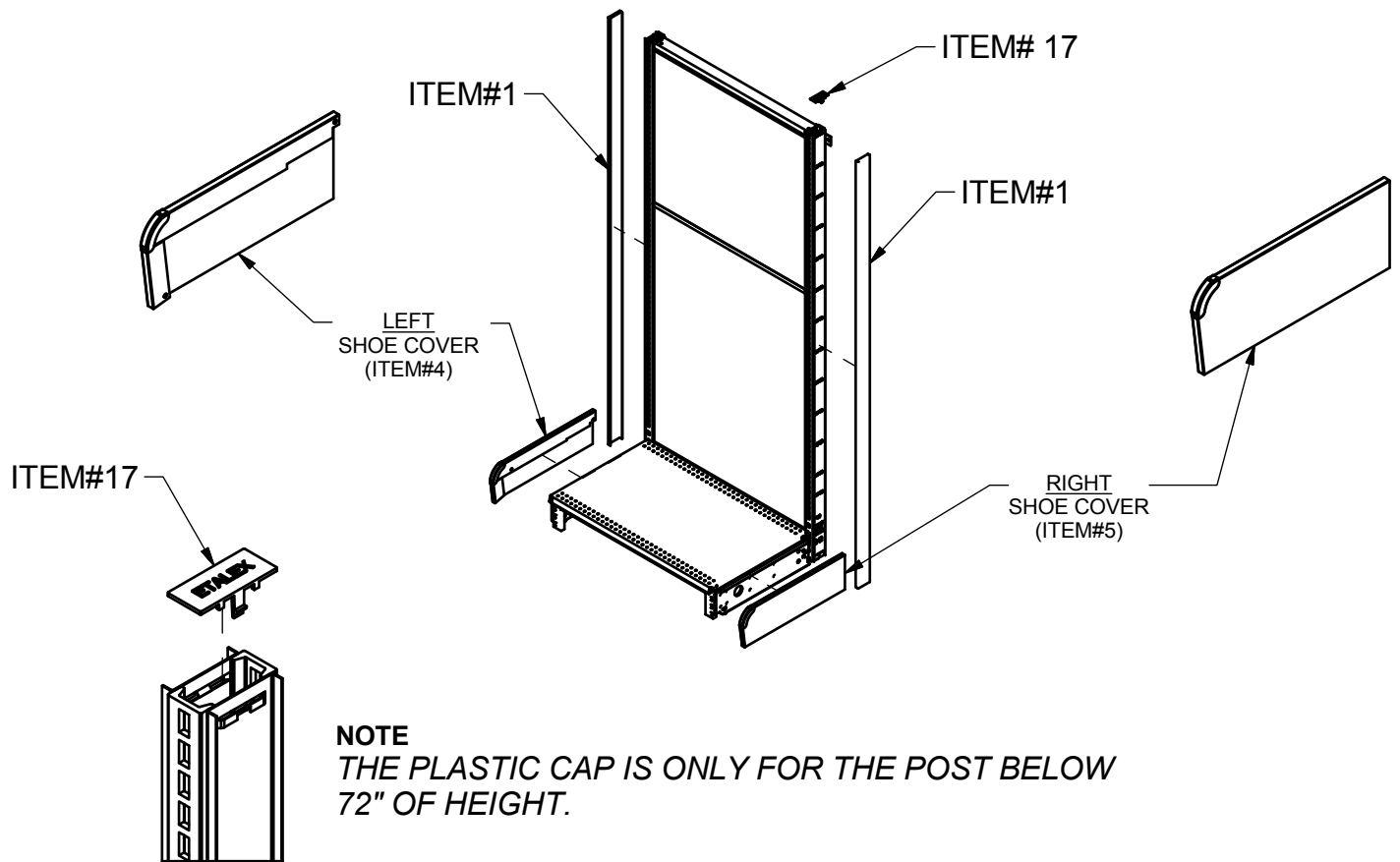

STEP 9

INSTALL UPPER SHELVES (ITEM#6) AT THE DESIRED HEIGHT.

MASONITE BACK PANEL SIZING CHART

UPRIGHT	LENGTH		FIRST MASONITE	SECOND MASONITE	CENTRAL CROSS BAR	INTERMEDIATE CROSS BAR.
	NOMINAL	REAL	HEIGHT	HEIGHT	QTY	QTY
32"	24"	22 9/16"	29 5/8"	N/A	N/A	1
	36"	34 9/16"	29 5/8"	N/A	N/A	1
36"	24"	22 9/16"	29 5/8"	N/A	N/A	1
	30"	28 9/16"	29 5/8"	N/A	N/A	1
	36"	34 9/16"	29 5/8"	N/A	N/A	1
	42"	40 9/16"	29 5/8"	N/A	N/A	1
42"	48"	46 9/16"	29 5/8"	N/A	N/A	1
	24"	22 9/16"	35 5/8"	N/A	N/A	1
	36"	34 9/16"	35 5/8"	N/A	N/A	1
48"	46"	46 9/16"	35 5/8"	N/A	N/A	1
	24"	22 9/16"	41 5/8"	N/A	N/A	1
	30"	28 9/16"	41 7/8"	N/A	N/A	1
54"	36"	34 9/16"	41 5/8"	N/A	N/A	1
	42"	40 9/16"	41 5/8"	N/A	N/A	1
	48"	46 9/16"	41 5/8"	N/A	N/A	1
	24"	22 9/16"	47 5/8"	N/A	N/A	1
60"	30"	28 9/16"	47 5/8"	N/A	N/A	1
	36"	34 9/16"	47 5/8"	N/A	N/A	1
	42"	40 9/16"	47 5/8"	N/A	N/A	1
	48"	46 9/16"	47 5/8"	N/A	N/A	1
	24"	22 9/16"	53 5/8"	N/A	N/A	1
66"	30"	28 9/16"	53 5/8"	N/A	N/A	1
	36"	34 9/16"	53 5/8"	N/A	N/A	1
	42"	40 9/16"	53 5/8"	N/A	N/A	1
	48"	46 9/16"	53 5/8"	N/A	N/A	1
72"	24"	22 9/16"	59 5/8"	N/A	N/A	1
	30"	28 9/16"	59 5/8"	N/A	N/A	1
	36"	34 9/16"	59 5/8"	N/A	N/A	1
	42"	40 9/16"	59 5/8"	N/A	N/A	1
	48"	46 9/16"	59 5/8"	N/A	N/A	1
78"	24"	22 9/16"	65 5/8"	N/A	N/A	1
	30"	28 9/16"	65 5/8"	N/A	N/A	1
	36"	34 9/16"	65 5/8"	N/A	N/A	1
	42"	40 9/16"	65 5/8"	N/A	N/A	1
	48"	46 9/16"	65 5/8"	N/A	N/A	1
84"	20"	18 9/16"	23 7/8"	47 5/8"	1	1
	24"	22 9/16"	23 7/8"	47 5/8"	1	1
	36"	34 9/16"	23 7/8"	47 5/8"	1	1
	42"	40 9/16"	23 7/8"	47 5/8"	1	1
	48"	46 9/16"	23 7/8"	47 5/8"	1	1
90"	24"	22 9/16"	29 7/8"	47 5/8"	1	1
	30"	28 9/16"	29 7/8"	47 5/8"	1	1
	36"	34 9/16"	29 7/8"	47 5/8"	1	1
	42"	40 9/16"	29 7/8"	47 5/8"	1	1
	48"	46 9/16"	29 7/8"	47 5/8"	1	1
96"	24"	22 9/16"	35 7/8"	47 5/8"	1	2
	30"	28 9/16"	35 7/8"	47 5/8"	1	2
	36"	34 9/16"	35 7/8"	47 5/8"	1	2
	42"	40 9/16"	35 7/8"	47 5/8"	1	2
	48"	46 9/16"	35 7/8"	47 5/8"	1	2
108"	24"	22 9/16"	41 7/8"	47 5/8"	1	2
	30"	28 9/16"	41 7/8"	47 5/8"	1	2
	36"	34 9/16"	41 7/8"	47 5/8"	1	2
	42"	40 9/16"	41 7/8"	47 5/8"	1	2
	48"	46 9/16"	41 7/8"	47 5/8"	1	2
108"	24"	22 9/16"	47 5/8"	53 7/8"	1	2
	36"	34 9/16"	47 5/8"	53 7/8"	1	2
	48"	46 9/16"	47 5/8"	53 7/8"	1	2

FOR TECHNICAL ASSISTANCE, CALL MIDWEST RETAIL SERVICES AT 800-876-7577

FOR YOUR SAFETY:

Install all shelving according to installation instructions.

Assembly or movement of any parts should only be carried out by trained personnel who have read and understand these instructions and warnings.

Do not use shelving parts or accessories for any purposes other than originally intended.

Do not combine Etalex products with non Etalex products.

Local codes and regulations concerning building, fire.

Sanitation or seismic requirements may apply to some installations. It is the responsibility of the buyer of the fixtures to make sure that they are installed in compliance with any applicable codes and/or regulations.

Do not install damaged parts.

Never after, modify or otherwise structurally change the shelving or any of its components.

Do not expose any sharp or pointed edges to shoppers or employees.

Never install shelves or accessories onto the side of an upright that has no base foot to support it.

Be sure all shelving parts or accessories are completely seated in slotting or perforations.

Do not permit climbing or standing on shelving at any time... including the base shelf.

No shelves or accessories should project past the front of the base shelf.

Do not move an assembled unit, especially if merchandised.

Do not lean heavy items against the shelves.

Provide safe access to all merchandised items in accordance with applicable **osha/wcb/csst** regulations.

UNBALANCED LOAD CALCULATION

FOR A WALL SECTION HEAVY LOADED **OR** WHEN LOADING **OR** UNLOADING AN ISLAND. IT IS VERY IMPORTANT TO DETERMINE THAT YOU WILL NOT CREATE AN UNBALANCED LOAD THAT WILL EXCEED THE LIMIT PERMITTED. THE EXAMPLE SHOWN BELOW WILL SHOW YOU HOW TO CALCULATE IF YOU HAVE AN UNBALANCED LOAD IN LBS/INCH.

NOTE : POUND-INCH IS A MEASURE OF THE SHELF LOADS ACTING AT A DISTANCE FROM THE UPRIGHT (1/2 THE DEPTH OF THE SHELF).

EXAMPLE :

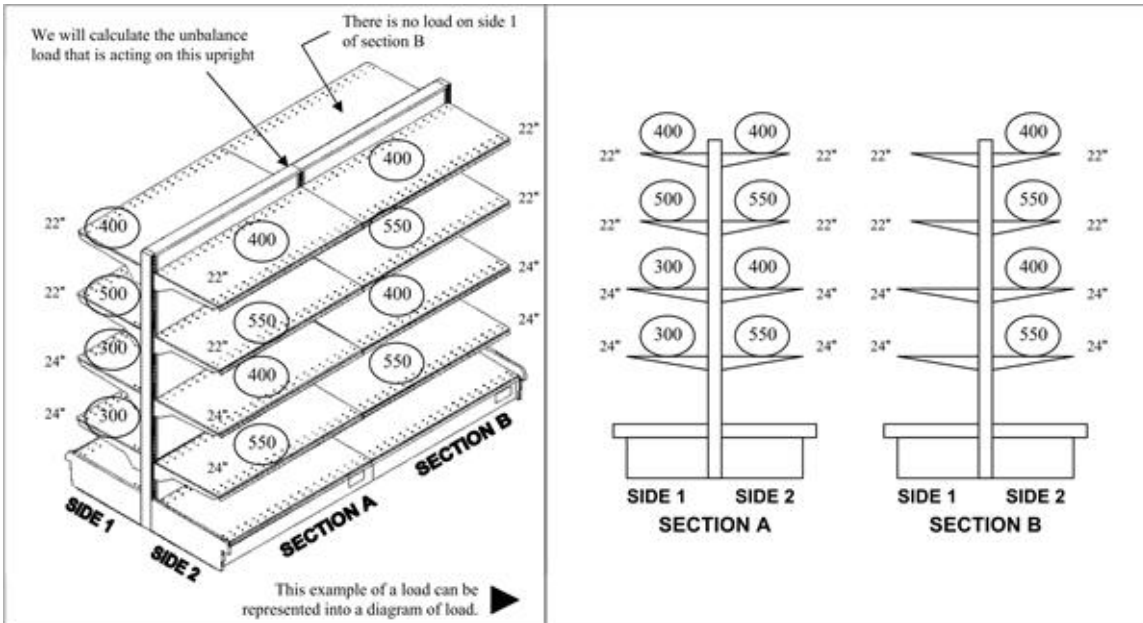

NOTE : Shelf depth is divided by 2 because an evenly distributed shelf load is calculated as a total load at center of shelf depth.

Shelf load is divided by 2 because a shelf load is supported by two uprights.

WALL SECTION UNBALANCED LOAD CALCULATION :

Wall section is the same as the method shown for an island section. Simply consider the side without shelves having a load of zero.

	(Shelf depth / 2) x (Shelf load / 2)	SIDE 1 POUNDS-INCH	SIDE 2 POUNDS-INCH
SECTION A	11 x 200 =	2200	
	11 x 250 =	2750	
	12 x 150 =	1800	
	12 x 150 =	1800	
	11 x 200 =		2200
	11 x 275 =		3025
	12 x 200 =		2400
	12 x 275 =		3300
SECTION B	11 x 200 =		2200
	11 x 275 =		3025
	12 x 200 =		2400
	12 x 275 =		3300
TOTAL (Section A and B)		8550	21850

CAUTION :

Subtract the smaller unbalanced load from the larger :
 This is the total unbalanced load acting on the upright.

21850
- 8550
13300

In this example, 13300 inch-pounds does not exceed the 18,000 inch-pounds limit. However, note that the total of section A and B on Side 2 is 21850 Pounds-inch. This means that Side 2 would exceed the 18,000 inch-pound limit if loaded before Side 1, or if Side 1 was unloaded before Side 2. Therefore, in the above example, Side 1 (the side with the smaller load) must be loaded before Side 2 is loaded, and Side 2 must be unloaded to less than 18,000 inch-pounds before Side 1 is unloaded.

SERIE S AND HYBRID : DO NOT EXCEED 15.500 POUND-INCH UNBALANCED LOAD