

# MIDWEST

RETAIL SERVICES, Inc

## RTA CUBE ASSEMBLY INSTRUCTIONS

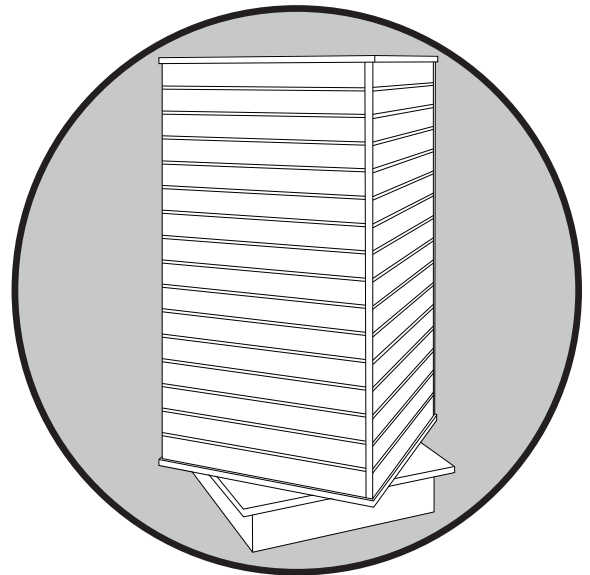

### TOOLS NEEDED



#2 Phillips Screwdriver



Rubber Mallet  
(optional)

### KIT COMPONENTS



Cube Panel x 4

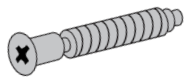

Confirmat Screw x 20



Camlock Pin x 12

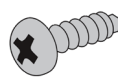

Pan Head Screw x 16

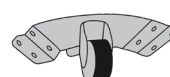

Caster x 4

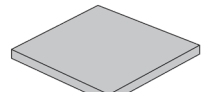

Cube Top x 1

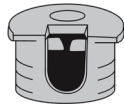

Camlock x 12

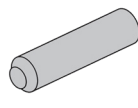

Dowel Pin x 8

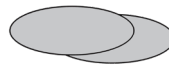

Screw Cap x 20

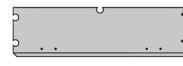

Kick Base Board x 4

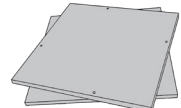

Spinner Base Top x 1

### KICK BASE ASSEMBLY

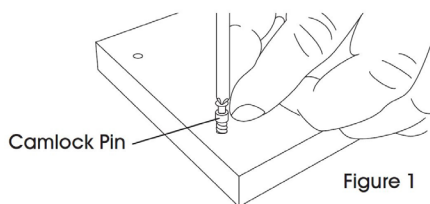

Figure 1

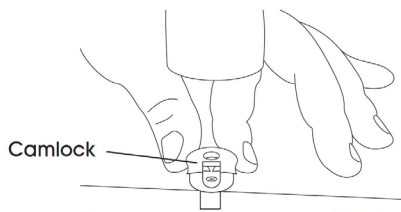

Figure 2

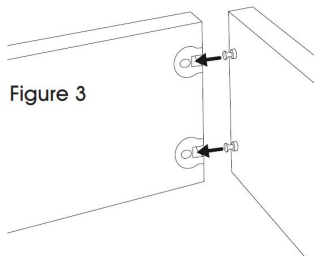

Figure 3

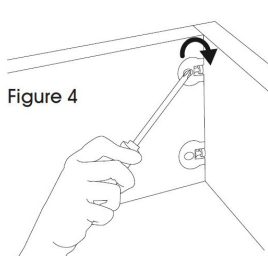

Figure 4

- 1 Using a #2 Phillips screwdriver, install the camlock pins into the pre-drilled holes in the (4) kick base boards. (See Figure 1)
  - 2 Install camlocks into the large holes in the kick base boards and tap into position with the rubber mallet. (See Figure 2)
- NOTE:** Ensure the hole in the side of the camlock faces outward.
- 3 Arrange the (4) kick base boards to form a square. At each corner of the square, set the camlock pins of one board into the camlocks of the adjacent board. (See Figure 3)
  - 4 Connect the camlocks and pins by inserting the screwdriver into the top hole of the camlock and turning clockwise. (See Figure 4)

**PRO TIP:** Tilt the screwdriver at an upward angle while twisting to better lock the camlocks.

## SPINNER BASE ASSEMBLY

- 1 Set the spinner base top on a protected surface. Make sure the underside of the spinner base top is facing up.
- 2 Install the camlock pins into the pre-drilled holes of the spinner base using the screwdriver. (See Figure 1)
- 3 Set the kick base onto the spinner base, aligning the camlocks and camlock pins, and tighten the camlocks. (See Figure 5)

Figure 5

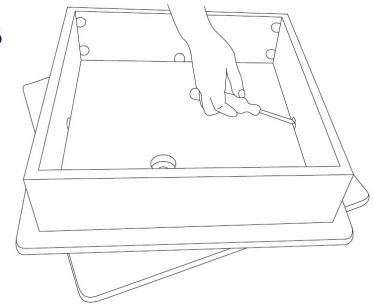

**NOTE:** If you do not want the spinner base to rotate, install a screw through the bottom base panel into the top base panel, taking care not to puncture through the surface of the top base panel. This will stabilize the spinner component of the base unit.

## CASTER INSTALLATION (OPTIONAL)

Figure 6

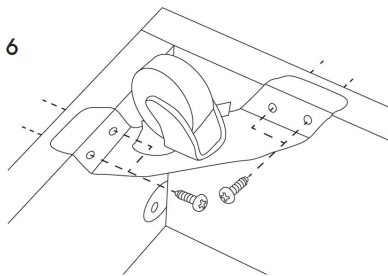

- 1 Position the casters onto each of the four corners of the kick base assembly. (See Figure 6)
- 2 Using (4) pan head screws per castor, attach the casters through the pre-drilled holes on the inside corners of the kick base. (See Figure 6)

**PRO TIP:** Install all screws before the final tightening to allow for easier alignment of casters.

## CUBE PANEL INSTALLATION

- 1 Flip the spinner base top so that the right side is up.
- 2 Insert (4) wooden dowel pins into the pre-drilled holes on the base top and tap them into position with a rubber mallet.

**NOTE:** Two people are recommended for steps 3 through 5.

- 3 Install (2) panels onto the dowel pins so that they form a corner. Locate the holes on the bottom of the panels and guide them onto the dowel pins. (See Figure 7)
- 4 Attach the panels together by installing confirmat screws into the pre-drilled holes using a #2 Phillips screwdriver. (See Figure 8)

**PRO TIP:** Do not fully tighten the screws until all the cube panels are in place.

Figure 7

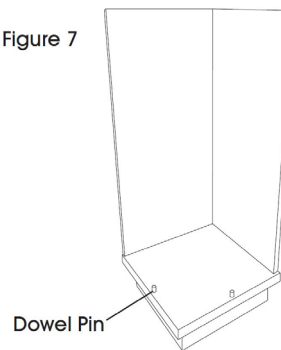
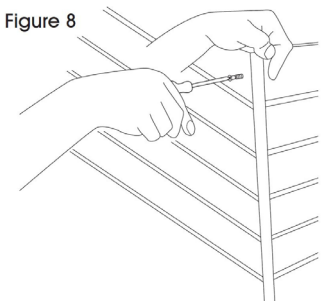

Figure 8



Dowel Pin

- 5 Install the remaining panels in the same manner to complete the unit.
- 6 Once the cube panels are in place, tighten all screws completely.

## CUBE TOP INSTALLATION

Figure 9

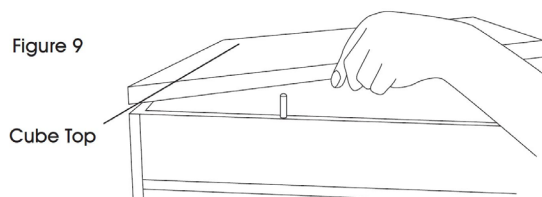

- 1 Fit the cube top onto the panels with the dowel pins provided. (See Figure 9)
- 2 To conceal the screw heads, peel the decorative screw cover caps to expose the sticky back, carefully center over the screw heads, and press in place.