

# GONDOLA SYSTEM

## GONDOLA SYSTEM

Gondolas are a classic fixture, a go-to for retailers because of their strength and durability. As versatile fixtures, they are easy to customize with add-ons and finishes to enhance your product presentation. Who knows more about gondola shelving than Lozier?

We're proud to have originated the industry standard, but you'll be surprised at all the ways you can use this versatile system.



ISLAND SECTION

WALL SECTION

## HOW IT WORKS

- Sections can be combined for any run length
- Shelving run consists of a number of sections and 1 end unit



# ISLAND GONDOLA DIMENSIONS

• All dimensions are nominal. If exact dimensions are required, please contact your Lozier representative.

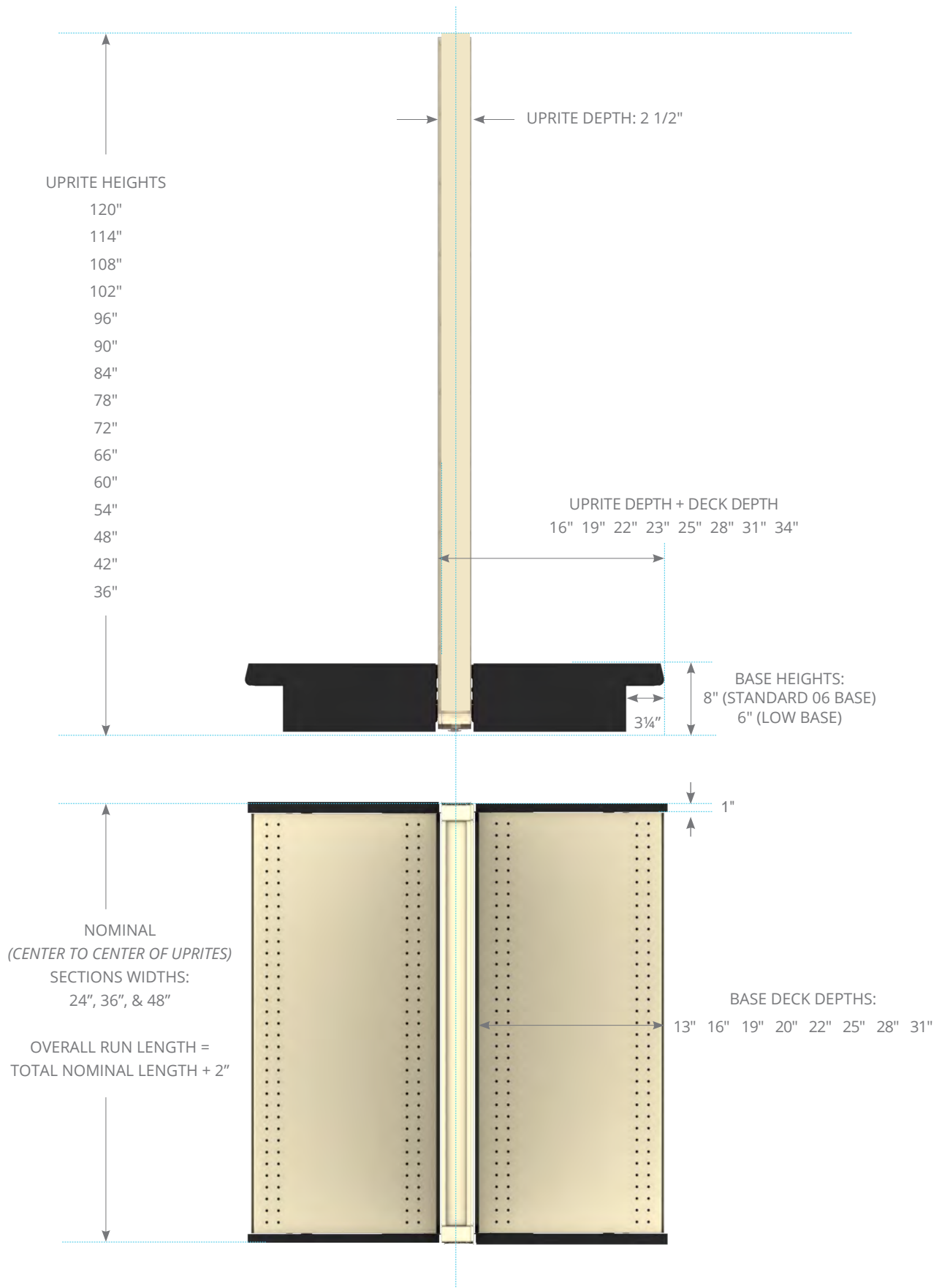

# WALL GONDOLA DIMENSIONS

• All dimensions are nominal. If exact dimensions are required, please contact your Lozier representative.

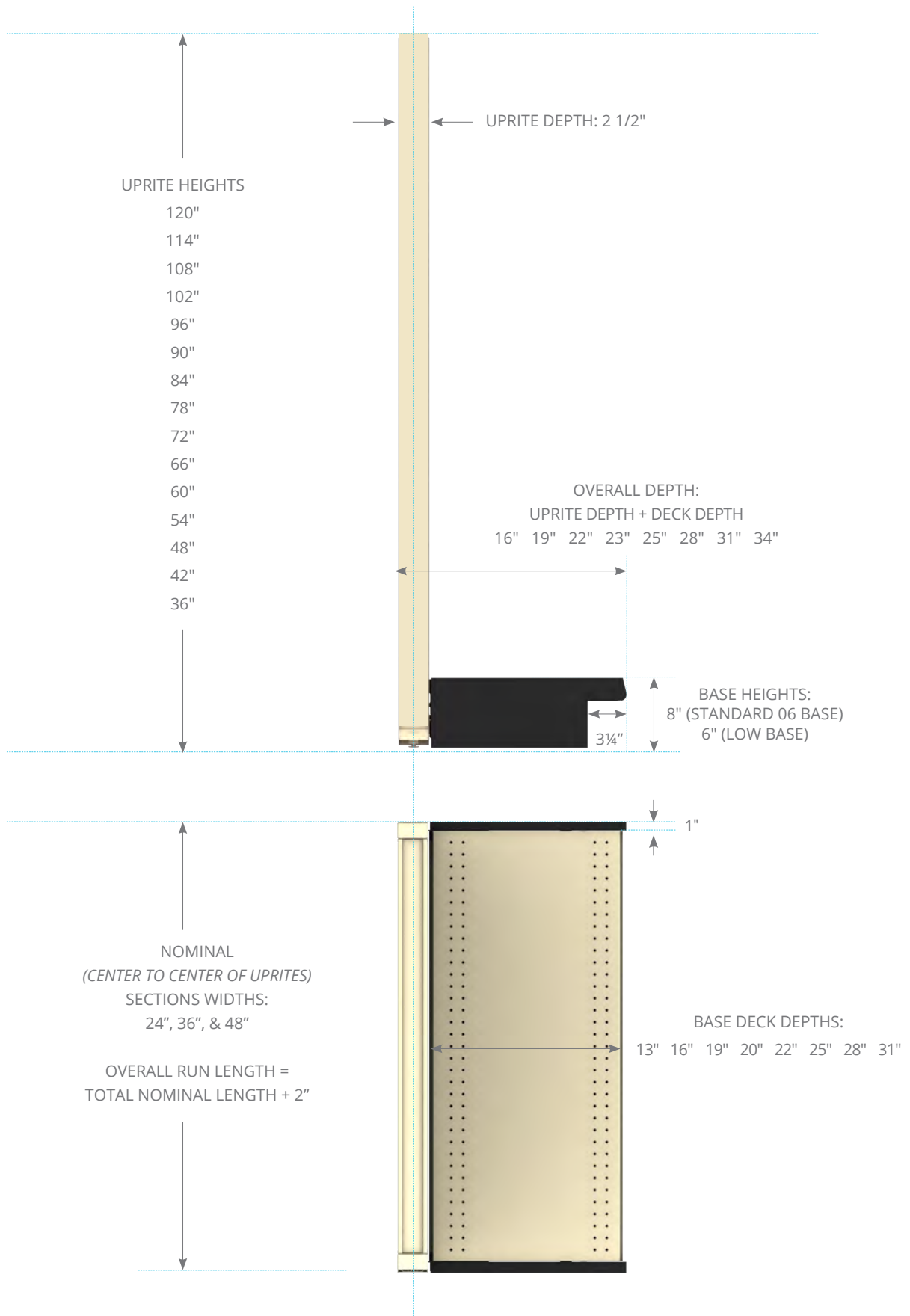

# ISLAND SECTION

• Use the Island Section part number scheme below to create your Island run

## INCLUDES

- A** 1 Upright
- B** 2 Base Brackets
- C** 2 Base Decks
- D** 2 Closed Base Fronts
- E** 1 Top Rail
- F** 1 Center Rail (2 on 96-144"H)
- G** 1 Bottom Rail
- H** 1 Splicer Rail (78"-144"H)
- I** Back Material



## BACK OPTIONS

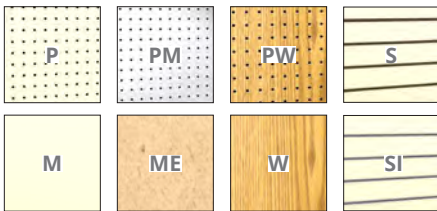

**Example Part #:** IS 4 54 19 19 06 S CBF CHR PLT PLT P PLT M PLT S N PLT S N PLT  
 1. 2. 3. 4. 5. 6. 7. 9. 10. 11. 12. 13. 14. 15. 16. 17. 18. 19. 20. 21. 22.

1. **Island Section: IS**
2. **Section Width: 2', 3', 4'**
3. **Height:** 36", 42", 48", **54"**, 60", 66", 72", 78", 84", 90", 96", 102", 108", 114", 120"
4. **Base Deck Depth, Side A:** 13", 16", **19"**, 22", 25", 28", 31"
5. **Base Deck Depth, Side B:** 13", 16", **19"**, 22", 25", 28", 31"
6. **Base Type: 06**, LB
7. **Spring Locking Base Bracket: S**
8. **Rail Type:** T, **Omit** for regular rails
9. **Base Front: CBF**, OBF
10. **Base Front Color: CHR**
11. **Upright Color: PLT**, Optional Catalog Colors
12. **Back Rail Color: PLT**, Optional Catalog Colors
13. **Back Material, Side A:** P, M, S, SI, ME, W, PW, PM, NBR
14. **Back Color, Side A: PLT**, Optional Catalog Colors
15. **Back Material, Side B:** P, M, S, SI, ME, W, PW, PM, NBR
16. **Back Color, Side B: PLT**, Optional Catalog Colors
17. **Deck, Side A: S**, HDSD
18. **Deck Molding, Side A: N**, M13S, M13G, M55S, M55G, M35S, M35G, MR1S, MR1G
19. **Deck Color, Side A: PLT**, Optional Catalog Colors
20. **Deck, Side B: S**, HDSD
21. **Deck Molding, Side B: N**, M13S, M13G, M55S, M55G, M35S, M35G, MR1S, MR1G
22. **Deck Color, Side B: PLT**, Optional Catalog Colors

# ISLAND END

- Use the Island End part number scheme below to finish your Island run

## INCLUDES

- A** 1 Upright
- B** 2 Base Brackets
- C** 2 Pair Base End Trim
- D** 2 Upright End Trims

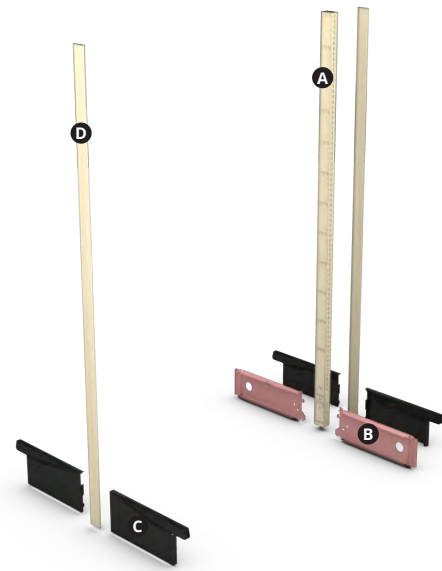

**Example Part # :**    **IE 54 19 19 06 S CHR PLT**  
                                   1.    2.    3.    4.    5.    6.    8.    9.

- Island End: IE**
- Height:** 36", 42", 48", **54"**, 60", 66", 72", 78", 84", 90", 96", 102", 108", 114", 120"
- Base Deck Depth, Side A:** 13", 16", **19"**, 22", 25", 28", 31"
- Base Deck Depth, Side B:** 13", 16", **19"**, 22", 25", 28", 31"
- Base Type: 06**, LB
- Spring Locking Base Bracket: S**
- Options:** O, P, X, **Omit** if not required
- Base End Trim Color: CHR**
- Upright & Upright End Trim Color: PLT**, Optional Catalog Colors

**⚠ SEE PRODUCT SAFETY INFORMATION PAGE 235**

## SUFFIX KEY

|  | BACK MATERIALS                               | MOLDING OPTIONS          |
|--|--|--------------------------|
| 06 = 06 Base (8"H)   | P = Pegboard (Island Section Lines #13 &15)  | N = No Molding           |
| LB = Low Base (6"H)  | PM = Mirrored Pegboard                       | M13S = M13 Satin Molding |
| T = Telescopic Rails   | PW = Peg Woodgrain                           | M13G = M13 Gold Molding  |
| CBF = Closed Base Front  | S = Slotwall (Island Section Lines #13 & 15) | M55S = M55 Satin Molding |
| OBF = Open Base Front  | SI = Slotwall with Inserts                   | M55G = M55 Gold Molding  |
| S = Standard Deck (Island Section Lines #17 & 20)  | M = Marteck                                  | M35S = M35 Satin Molding |
| HDSD = Heavy Duty Deck   | ME = Econo Marteck                           | M35G = M35 Gold Molding  |
| O = Use when ordering Open Base Front on Island Sections   | W = Woodgrain                                | MR1S = MR1 Satin Molding |
| P = Deletes the Upright End Trim so that a different trim package, or a standard trim color other than the Upright color, can be added. (Island End Line #7) | NBR = No Backs or Rails                      | MR1G = MR1 Gold Molding  |
| X = Extended Base End Trim required when using M55_Molding on Base Deck. This replaces the standard Base End Trim  |  |                          |
| CHR = Charcoal Black Paint   |  |                          |
| PLT = Platinum Paint   |  |                          |

# WALL SECTION

- Use the Wall Section part number scheme below to create your Wall run

## INCLUDES

- A** 1 Upright
- B** 1 Base Bracket
- C** 1 Base Deck
- D** 1 Closed Base Front
- E** 1 Top Rail
- F** 1 Center Rail (2 on 96"-120"H)
- G** 1 Bottom Rail
- H** 1 Splicer Rail (78"-120"H)
- I** Back Material

## BACK OPTIONS

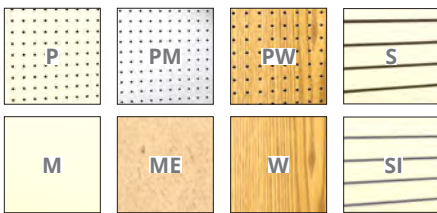

|                         |           |          |           |           |           |          |            |            |            |            |          |            |          |          |            |
|-------------------------|-----------|----------|-----------|-----------|-----------|----------|------------|------------|------------|------------|----------|------------|----------|----------|------------|
| <b>Example Part # :</b> | <b>WS</b> | <b>4</b> | <b>54</b> | <b>19</b> | <b>06</b> | <b>S</b> | <b>CBF</b> | <b>CHR</b> | <b>PLT</b> | <b>PLT</b> | <b>P</b> | <b>PLT</b> | <b>S</b> | <b>N</b> | <b>PLT</b> |
|                         | 1.        | 2.       | 3.        | 4.        | 5.        | 6.       | 8.         | 9.         | 10.        | 11.        | 12.      | 13.        | 14.      | 15.      | 16.        |

1. **Wall Section: WS**
2. **Section Width: 2', 3', 4'**
3. **Height: 36", 42", 48", 54", 60", 66", 72", 78", 84", 90", 96", 102", 108", 114", 120"**
4. **Base Deck Depth: 13", 16", 19", 22", 25", 28", 31"**
5. **Base Type: 06, LB**
6. **Spring Locking Base Bracket: S**
7. **Rail Type: T, Omit** for regular rails
8. **Base Front: CBF, OBF**
9. **Base Front Color: CHR**
10. **Upright Color: PLT, Optional Catalog Colors**
11. **Back Rail Color: PLT, Optional Catalog Colors**
12. **Back Material: P, M, S, SI, ME, W, PW, NBR**
13. **Back Color: PLT, Optional Catalog Colors**
14. **Deck Type: S, HDSD**
15. **Deck Molding: N, M13S, M13G, M55S, M55G, M35S, M35G, MR1S, MR1G**
16. **Deck Color: PLT, Optional Catalog Colors**

# WALL END

- Use the Wall End part number scheme below to finish your Wall run

## INCLUDES

- A** 1 Uprite
- B** 1 Base Bracket
- C** 1 Pair Base End Trim
- D** 2 Uprite End Trims

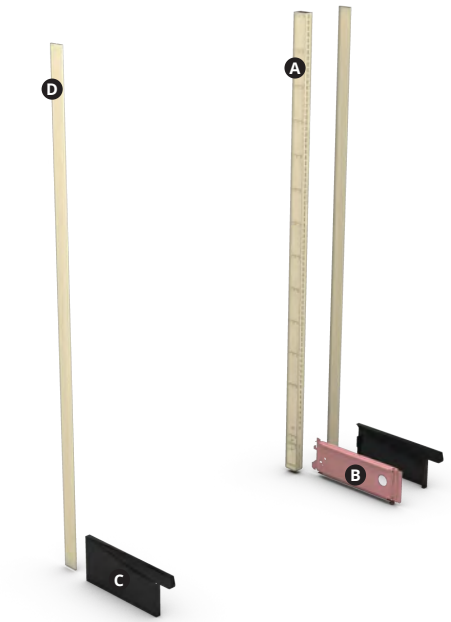

**Example Part #:**    **WE 54 19 06 S CHR PLT**

1.    2.    3.    4.    5.    7.    8.

1. **Wall End: WE**
2. **Height:** 36", 42", 48", **54"**, 60", 66", 72", 78", 84", 90", 96", 102", 108", 114", 120"
3. **Base Deck Depth:** 13", 16", **19"**, 22", 25", 28", 31"
4. **Base Type: 06**, LB
5. **Spring Locking Base Bracket: S**
6. **Options:** O, P, X, **Omit** if not required
7. **Base End Trim Color: CHR**
8. **Uprite & Uprite End Trim Color: PLT**, Optional Catalog Colors

**⚠ SEE PRODUCT SAFETY INFORMATION PAGE 235**

## SUFFIX KEY

|   | BACK OPTIONS                         | MOLDING OPTIONS          |
|---|--------------------------------------|--------------------------|
| 06 = 06 Base (8"H)  | P = Pegboard (Wall Section Line #12) | N = No Molding           |
| LB = Low Base (6"H)   | PM = Mirrored Pegboard               | M13S = M13 Satin Molding |
| T = Telescopic Rails  | PW = Peg Woodgrain                   | M13G = M13 Gold Molding  |
| CBF = Closed Base Front   | S = Slotwall (Wall Section Line #12) | M55S = M55 Satin Molding |
| OBF = Open Base Front   | SI = Slotwall with Inserts           | M55G = M55 Gold Molding  |
| S = Standard Deck (Wall Section Line #14)   | M = Marteck                          | M35S = M35 Satin Molding |
| HDSD = Heavy Duty Deck  | ME = Econo Marteck                   | M35G = M35 Gold Molding  |
| O = Use when ordering Open Base Front on Island Sections  | W = Woodgrain                        | MR1S = MR1 Satin Molding |
| P = Deletes the Uprite End Trim so that a different trim package, or a standard trim of color other than the Uprite color, can be added. (Wall End Line #6) | NBR = No Backs or Rails              | MR1G = MR1 Gold Molding  |
| X = Extended Base End Trim required when using M55_Molding on Base Deck. This replaces the standard Base End Trim   |                                      |                          |
| PLT = Platinum Paint  |                                      |                          |
| CHR = Charcoal Black Paint  |                                      |                          |



## UPRITE

---

- 3/16" thick face channel
- 1" slotted on center for maximum flexibility
- Use for Wall and Island Sections
- Steel welded construction
- Includes side flanges to retain Back material, leveling leg for uneven floors
- Includes Top Caps on Uprites 36"-66"H

**Example Part # :**    **U 42 PLT**

---

1. **Uprite: U**
2. **Height:** 30", 36", **42"**, 48", 54", 60", 66", 72", 78", 84", 90", 96", 102", 108", 114", 120"
3. **Standard Finish: PLT**, Optional Catalog Colors



## UPRITE/EXTENSION UPRITE END TRIM

---

- One-piece trim (Two-pieces if 108"-144"H) snaps onto first and last Uprite or Extension Uprite in a run
- Can be used on both sides of Extension Uprites where Extension Backs are not used

**Example Part # :**    **UET 48 PLT**

---

1. **Uprite/Extension Uprite End Trim: UET**
2. **Height:** 6", 12", 18", 24", 30" 36", 42", **48"**, 54", 60", 66", 72", 78", 84", 90", 96", 102", 108", 114", 120"
3. **Standard Finish: PLT**, Optional Catalog Colors

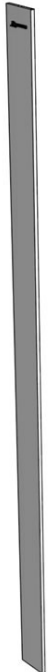

### SUFFIX KEY

PLT = Platinum Paint

## TELESCOPIC UPRITE SYSTEM

- Stores between the Back Panels and extends up to 30" above the Top Rail in 1" increments
- Locking Pin (included with Uprite) stores in the Top Cap when not in use
- Section length must be all 3' or 4', no combination of both in same run
- Will NOT work with Slotwall or Wire Grid Backs
- When ordering sections, specify "T" rail type

Example Part #: **TEL30 PLT**

1. **Telescopic Uprite System: TEL30**
2. **Standard Finish: PLT**, Optional Catalog Colors



### EXTRA LOCKING PINS

Part #: **TELP GLV**

1. **Extra Locking Pins: TELP**
2. **Standard Finish: GLV**



The load capacity per Telescopic Uprite section is 200 lbs per side no matter how many shelves are used on this section. This load capacity is reduced to 60 lbs per Telescopic Uprite section if used on a Wall Section with Backs installed on one side only

## WALL-MOUNT BRACKET

- Connect standard Uprites to building walls
- Place Brackets at minimum of 48" on center per Uprite height
- Extension Uprites require one Bracket for Uprites up to 36"H; two for Extensions over 36"
- Fasteners not included

Part #: **DC2191 GLV**

1. **Wall-Mount Bracket: DC2191**
2. **Standard Finish: GLV**

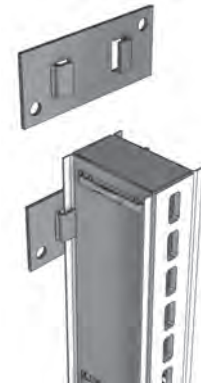

## WALL-MOUNT UPRITE

- Slotted 1" on center
- Attaching hardware not included
- WMU actual size is 1" shorter than nominal size

Example Part #: **WMU 48 PLT**

1. **Wall Mounted Uprite: WMU**
2. **Section Width: 48", 60", 72", 84" 90"**
3. **Standard Finish: PLT**, Optional Catalog Colors



### SUFFIX KEY

PLT = Platinum Paint

GLV = Galvanized

## BACK ADAPTER

- Allows BE Backs to be installed in previous style of 06 Base Uprites
- Adapter attaches to existing Uprite SAP Pin hole

Part #: **BKA GLV**

1. **Back Adapter: BKA**
2. **Standard Finish: GLV**



## TOP CAP

- Use Top Cap to close off the top of an Uprite for uniform finish
- Top Caps included with Uprites 36"-66"

Example Part #: **DC1561 PLT**

1. **Top Cap: DC1561**
2. **Standard Finish: PLT**, Optional Catalog Colors



STANDARD

## BASE BRACKET

- Features 2" conduit hole for greater electrical access
- Includes leveling legs for uneven flooring
- Install straight in using integral spring latch

Example Part #: **BB 13 06 S PTD**

1. **Base Bracket: BB**
2. **Deck Depth: 13"**, 16", 19", 22", 25", 28", 31"
3. **Base Height: 06**, LB
4. **Spring Locking Base Bracket: S**
5. **Standard Finish: PTD**, Optional CHR



 *Actual Bracket length is 3" less than nominal Deck depth. Order CHR Base Brackets when using Open Base Fronts. (This is done automatically when section/end part numbers are ordered with OBF's.)*

### SUFFIX KEY

GLV = Galvanized

LB = Low Base (6"H)

PLT = Platinum Paint

PTD = Painted Random

06 = 06 Base (8"H)

CHR = Charcoal Black Paint

## UPRITE/BASE BRACKET ANCHOR PLATES

- Accepts 1/4" or 3/8" diameter anchor bolts (not included)
- Use Anchor Plates when shelving unit exceeds height-to-depth ratio limits
- Required for shelving over 5' H in certain seismic zones
- Secures leveling leg to floor
- Multi-Purpose Anchor for end of run, Wall End Display or limited access applications

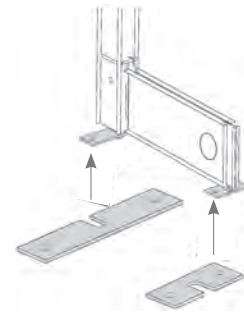

### A MULTI-PURPOSE ANCHOR PLATE

Part #: **DC1248** **GLV**

1. **Multi-Purpose Anchor Plate: DC1248**
2. **Standard Finish: GLV**

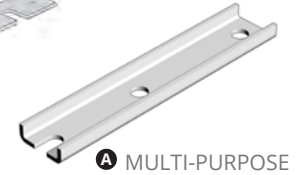

### B UPRITE ANCHOR PLATE

Part #: **DC1241** **GLV**

1. **Upright Anchor Plate: DC1241**
2. **Standard Finish: GLV**



### C BASE BRACKET ANCHOR PLATE

Part #: **DC1242** **GLV**

1. **Base Bracket Anchor Plate: DC1242**
2. **Standard Finish: GLV**



#### SUFFIX KEY

GLV = Galvanized

## BASE END TRIM

---

- Attaches to the first and last Base Bracket in a run
- Comes in a pair
- One pair is required to finish a Wall run
- Two pair are required to finish an Island run



**Example Part # :**    **BET 13 06 CHR**

---

1. **Base End Trim: BET**
2. **Deck Depth: 13"**, 16", 19", 22", 25", 28", 31"
3. **Base Height: 06**, LB
4. **Standard Finish: CHR**

## EXTENDED BASE END TRIM

---

- Use to cover the ends of M55 Molding in Island or Wall Sections
- Automatically supplied when M55 Molding is ordered in Island and Wall runs
- Comes in a pair
- One pair is required to finish Wall run
- Two pair are required to finish Island run

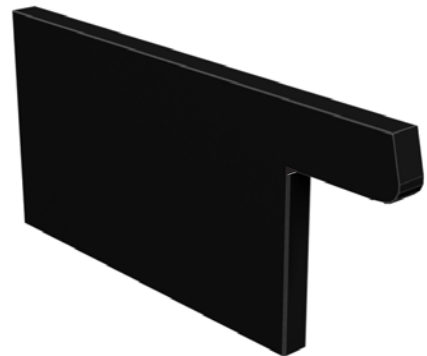

**Example Part # :**    **BETX 13 06 CHR**

---

1. **Extended Base End Trim: BETX**
2. **Deck Depth: 13"**, 16", 19", 22", 25", 28", 31"
3. **Base Height: 06**, LB
4. **Standard Finish: CHR**

### SUFFIX KEY

06 = 06 Base (8"H)

CHR = Charcoal Black Paint

LB = Low Base (6"H)

## CLOSED BASE FRONT

---

- 3' and 4' Fronts have an electrical knockout
- Snaps in place beneath Deck to cover gap between Deck and floor
- Fits flush with floor regardless of leveling adjustments

**Example Part # : CBF 4 06 CHR**

---

1. **Closed Base Front: CBF**
2. **Section Width: 2', 30", 3', 4'**
3. **Base Height: 06, LB**
4. **Standard Finish: CHR**



## OPEN BASE FRONT

---

- Use instead of Closed Base Front
- When using Open Base Front, order CHR Base Brackets. This is done automatically when complete Section/End part numbers are ordered.

**Example Part # : OBF 4 06 CHR**

---

1. **Open Base Front: OBF**
2. **Section Width: 2', 30", 3', 4'**
3. **Base Height: 06, LB**
4. **Standard Finish: CHR**



## GAP FILLER

---

- Use to fill the gap between the Bottom Rail and floor on rear side of the Wall Shelving
- Compatible with either 06 Base or Low Base

**Example Part # : GF 4 CHR**

---

1. **Gap Filler: GF**
2. **Section Width: 2', 30", 3', 4'**
3. **Standard Finish: CHR**



### SUFFIX KEY

06 = 06 Base (8"H)

CHR = Charcoal Black Paint

LB = Low Base (6"H)

## HARDBOARD BACK OPTIONS

- Use one-piece Backs for heights 36"-72"
- For heights above 72" order 2 backs, see table below
- Pegboard 9/32" diameter holes, 1" on center
- To order the correct size Back, take Upright height minus 6"

| SECTION HEIGHTS: 78"-120" |               |
|---------------------------|---------------|
| USE 2-PIECE BACKS         |               |
| UPRITE HEIGHT             | ORDER BACKS   |
| 78"                       | BE_36 + BE_36 |
| 84"                       | BE_30 + BE_48 |
| 90"                       | BE_36 + BE_48 |
| 96"                       | BE_42 + BE_48 |
| 102"                      | BE_66 + BE_30 |
| 108"                      | BE_66 + BE_36 |
| 114"                      | BE_66 + BE_42 |
| 120"                      | BE_66 + BE_48 |

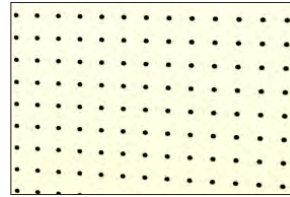

P=PEGBOARD  
PLT=PLATINUM

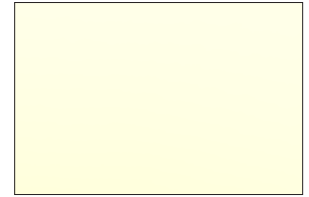

M=MARTECK  
PLT=PLATINUM

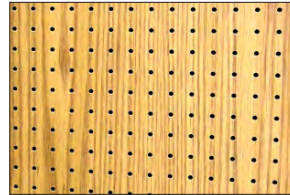

PW=PEG WOODGRAIN  
IA1=OAK



ME=ECONO MARTECK  
N/A=NO FINISH

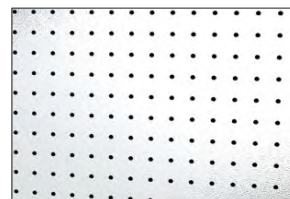

PM=MIRRORED PEGBOARD  
VA7=CHROME MYLAR



W=WOODGRAIN  
IA1=OAK

Example Part #: **BE 4 42 P PLT**

1. **Back Extension: BE**
2. **Width:** 06", 1', 16", 18", 2', 30", 32", 3', 42", 4'
3. **Nominal Back Height:** 6", 12", 18", 24", 30", 36", **42"**, 48", 54", 60", 66", 72"
4. **Back Panel Style:** P, M, ME, W, PW, PM
5. **Standard Finish:** PLT, IA1, N/A, VA7

### BACK DIMENSIONAL INFORMATION

| ACTUAL BACK HEIGHT INFORMATION |                     |               | ACTUAL WIDTH INFORMATION |              | ACTUAL BACK HEIGHT FOR EXTENSION UPRITE |               |
|--------------------------------|---------------------|---------------|--------------------------|--------------|---|---------------|
| UPRITE HEIGHT                  | NOMINAL BACK HEIGHT | ACTUAL HEIGHT | NOMINAL WIDTH            | ACTUAL WIDTH | UPRITE HEIGHT                           | ACTUAL HEIGHT |
| 30"                            | 24"                 | 23 13/16"     | 6"                       | 4 9/16"      | 6"                                      | 5 13/16"      |
| 36"                            | 30"                 | 29 13/16"     | 12"                      | 10 9/16"     | 12"                                     | 11 13/16"     |
| 42"                            | 36"                 | 35 13/16"     | 16"                      | 14 9/16"     | 18"                                     | 17 13/16"     |
| 48"                            | 42"                 | 41 13/16"     | 18"                      | 16 9/16"     | 24"                                     | 23 13/16"     |
| 54"                            | 48"                 | 47 13/16"     | 24"                      | 22 9/16"     | 30"                                     | 29 13/16"     |
| 60"                            | 54"                 | 53 13/16"     | 30"                      | 28 9/16"     | 36"                                     | 35 13/16"     |
| 66"                            | 60"                 | 59 13/16"     | 32"                      | 30 9/16"     | 42"                                     | 41 13/16"     |
| 72"                            | 66"                 | 65 13/16"     | 36"                      | 34 9/16"     | 48"                                     | 47 13/16"     |
|                                |                     |               | 42"                      | 40 9/16"     |   |               |
|                                |                     |               | 48"                      | 46 9/16"     |   |               |

### SUFFIX KEY

|                         |                             |
|-------------------------|-----------------------------|
| P = Pegboard Back       | PM = Mirrored Pegboard Back |
| M = Marteck Back        | PLT = Platinum Paint        |
| ME = Econo Marteck Back | IA1 = Oak Melamine          |
| W = Woodgrain Back      | N/A = No Finish             |
| PW = Peg Woodgrain Back | VA7 = Chrome Mylar          |

# 4' X 8' SHEET OF HARDBOARD BACKS

Example Part #: **BM4X8 P PLT**

1. **4' x 8' Back Extension: BM4X8**
2. **Back Panel Style: P, M, ME, W, PW, PM**
3. **Standard Finish: PLT, IA1, N/A, VA7**



## HARDBOARD BACK RAILS

- All Island and Wall Sections require one Top, Center and Bottom Rail
- 78"H - 144"H Backs require one Splicer Rail
- 96"H-144"H Backs require two Center Rails
- Splicer rail is not available in 2' or 30"
- 2' and 30" sections use two Top Rails to make a Splicer Rail
- Center Rail finish is always N/A because it's hidden
- Electrical knockouts included on all Rails

Example Part #: **R 2 B PLT**

1. **Rails: R**
2. **Width: 2', 30", 3', 4'**
3. **Rail Style: T, C, S, B**
4. **Standard Finish: PLT, Optional Catalog Colors, N/A (Center Rail Only)**



T=TOP RAIL



C=CENTER RAIL



S=SPLICER RAIL



B=BOTTOM RAIL

### SUFFIX KEY

|                             |                    |
|-----------------------------|--------------------|
| P = Pegboard Back           | IA1 = Oak Melamine |
| M = Marteck Back            | N/A = No Finish    |
| ME = Econo Marteck Back     | VA7 = Chrome Mylar |
| W = Woodgrain Back          | T = Top Rail       |
| PW = Peg Woodgrain Back     | C = Center Rail    |
| PM = Mirrored Pegboard Back | S = Splicer Rail   |
| PLT = Platinum Paint        | B = Bottom Rail    |



## SLOTWALL BACK OPTIONS

- Nominal Back height is Upright height minus 6"
- Features "T" slot 3" on center that accepts standard Slotwall Accessories
- Exterior finish: painted or laminate
- Order Aluminum Inserts for enhanced hanging strength
- Laminate strip insert available (factory-installed)
- Slotwall Backs require a minimum of 60" clearance above the shelving to install



S=SLOTWALL  
SI=SLOTWALL WITH INSERTS



L=LAMINATE INSERT



A=ALUMINUM INSERT  
ALU=ALUMINUM FINISH

| WALL OR ISLAND BACK HEIGHT                                   |                         |                            |            |
|--|-------------------------|----------------------------|------------|
| NOMINAL WIDTH: 6", 1', 16", 18", 2', 30", 32", 3', 42" OR 4' |                         |                            |            |
| UPRITE HEIGHT  | EXTENSION UPRITE HEIGHT | PART #                     | COMPONENTS |
|  | 12"                     | SEB_12 = BE_12S            |            |
|  | 18"                     | SEB_18 = BE_18S            |            |
|  | 24"                     | SEB_24 = BE_24S            |            |
| 36"  | 30"                     | SEB_30 = BE_30S            |            |
| 42"  | 36"                     | SEB_36 = BE_36S            |            |
| 48"  | 42"                     | SEB_42 = BE_42S            |            |
| 54"  | 48"                     | SEB_48 = BE_48S            |            |
| 60"  | 54"                     | SEB_54 = BE_54S            |            |
| 66"  | 60"                     | SEB_60 = BE_60S            |            |
| 72"  |                         | SEB_66 = BLE_48S + BU_18S  |            |
| 78"  |                         | SEB_72 = BLE_60S + BU_12S  |            |
| 84"  |                         | SEB_78 = BLE_60S + BU_18S  |            |
| 85"  |                         | SEB_79 = BLE_60S + BU_24S  |            |
| 90"  |                         | SEB_84 = BLE_60S + BU_24S  |            |
| 96"  |                         | SEB_90 = BLE_48S + BU_42S  |            |
| 102"   |                         | SEB_96 = BLE_60S + BU_36S  |            |
| 108"   |                         | SEB_102 = BLE_60S + BU_42S |            |
| 114"   |                         | SEB_108 = BLE_60S + BU_48S |            |
| 120"   |                         | SEB_114 = BLE_60S + BU_54S |            |

Example Part #: **SEB 4 42 A PLT ALU**  
 1. 2. 3. 4. 5. 6.

1. **Slotwall Back Extension: SEB**
2. **Width: 2', 30", 3', 4'**
3. **Nominal Back Height: 12", 18", 24", 30", 36", 42", 48", 54", 60", 66", 72", 78", 84", 90", 96", 102", 108", 114", 120"**
4. **Optional Aluminum or Laminate Insert: A, L, Omit if not required**
5. **Standard Back Finish: PLT, Optional Catalog Colors**
6. **Insert Finish (if required): ALU, Optional Catalog Colors and Laminate**

### SUFFIX KEY

|                     |                      |
|---------------------|----------------------|
| A = Aluminum Insert | PLT = Platinum Paint |
| L = Laminate Insert | ALU = Aluminum       |

## SLOTWALL SNAP-IN INSERTS

- Field-installed
- Order backs without inserts and order Snap-In Inserts separately
- Finish codes starting with X are plastic

| Part #              | Standard Finish              |
|---------------------|------------------------------|
| 34"W: <b>DB5183</b> | <b>X17,</b><br>X18, X19, X16 |
| 46"W: <b>DB5182</b> |                              |
| 96"W: <b>DB5181</b> |                              |



SNAP-IN INSERTS

| SLOTWALL SNAP-IN INSERTS |                       |
|--------------------------|-----------------------|
| HEIGHT                   | # OF INSERTS REQUIRED |
| 12"                      | 3                     |
| 18"                      | 5                     |
| 24"                      | 7                     |
| 30"                      | 9                     |
| 36"                      | 11                    |
| 42"                      | 13                    |
| 48"                      | 15                    |
| 54"                      | 17                    |
| 60"                      | 19                    |
| 66"                      | 21                    |
| 72"                      | 23                    |
| 78"                      | 25                    |
| 84"                      | 27                    |
| 90"                      | 29                    |
| 102"                     | 33                    |
| 114"                     | 37                    |

## 4' X 8' SHEET OF SLOTWALL BACKS

- Slotwall and Slotwall with Inserts also available
- S, SI slots run 8'

Example Part #: **BM4X8 S PLT**

1. **4'x8' Sheet: BM4X8**
2. **Back Panel Style: S, SI**
3. **Standard Finish: PLT**, Optional Catalog Colors
4. **Insert Finish (if required):** ALU, Optional Catalog Colors and Laminates

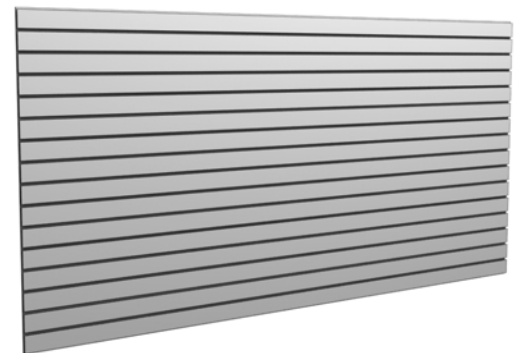

### SUFFIX KEY

|                            |                            |
|----------------------------|----------------------------|
| X17 = Red Plastic Insert   | S = Slotwall               |
| X18 = Black Plastic Insert | SI = Slotwall with Inserts |
| X19 = White Plastic Insert | PLT = Platinum Paint       |
| X16 = Gray Plastic Insert  | ALU = Aluminum             |

## UPPER EXTENSION SLOTWALL BACK

- Upper piece of Slotwall

| Example Part # : | BU | 4  | 42 | S  | PLT |
|------------------|----|----|----|----|-----|
|                  | 1. | 2. | 3. | 4. | 5.  |

1. **Upper Extension: BU**
2. **Width: 2', 30", 3', 4'**
3. **Nominal Back Height: 12", 18", 24", 36", 42", 48", 54"**
4. **Back Panel Style: S, SI**
5. **Standard Finish: PLT**
6. **Insert Finish (if required):** ALU, Optional Catalog Colors and Laminates

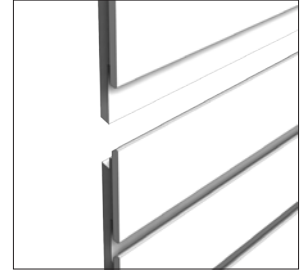

BU=UPPER EXTENSION



BLE=LOWER EXTENSION

## LOWER EXTENSION SLOTWALL BACK

- Lower piece of Slotwall

| Example Part # : | BLE | 4  | 48 | S  | PLT |
|------------------|-----|----|----|----|-----|
|                  | 1.  | 2. | 3. | 4. | 5.  |

1. **Lower Extension: BLE**
2. **Width: 2', 30", 3', 4'**
3. **Nominal Back Height: 48", 60"**
4. **Back Panel Style: S, SI**
5. **Standard Finish: PLT**, Optional Catalog Colors
6. **Insert Finish (if required):** ALU, Optional Catalog Colors and Laminates

### SUFFIX KEY

S = Slotwall

PLT = Platinum Paint

SI = Slotwall with Inserts

ALU = Aluminum

## SLOTWALL BACK RAILS

- Slotwall Island and Wall Sections require at least one Top, Slotwall Center, and Heavy Duty Bottom Rail
- Order one Slotwall Center Rail for 36" - 66"H Uprites
- Order two Slotwall Center Rails for 72" - 144"H Uprites
- Use one Slotwall Center Rail on 12" - 48"H Extension Uprites

Example Part #: **R 4 SC PLT**

1. **Rails: R**
2. **Width: 2', 30", 3', 4'**
3. **Rail Style: T, SC, HDB**
4. **Standard Finish: PLT**, Optional Catalog Colors (Slotwall Center Rail PLT only)

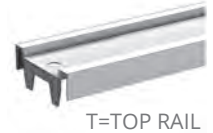

T=TOP RAIL



SC=SLOTWALL CENTER RAIL



HDB=HEAVY DUTY BOTTOM RAIL

## SLOTWALL WITH HARDBOARD BACK RAILS

- Slotwall with Hardboard Island and Wall Sections require at least one Top, Slotwall Center, Hardboard Back Support Clip, and Heavy Duty Bottom Rail
- 36" - 66"H Uprite requires: one Center Rail and one Support Clip
- 72" - 144"H Uprite requires: two Center Rails, two Support Clips and one Half Splicer
- On Extension Uprites, use one Slotwall Center Rail on 12" - 60"H Uprites and two on 66" - 72"H Uprites
- Electrical knockouts included on Top Rails
- For 2' and 30" sections, use Standard Duty Bottom Rail (Heavy Duty Bottom Rail unavailable)

Example Part #: **R 4 SC PLT**

1. **Rails: R**
2. **Width: 2', 30", 3', 4'**
3. **Rail Style: T, HS, SC, HDB**
4. **Standard Finish: PLT**, Optional Catalog Colors (Slotwall Center Rail PLT only)

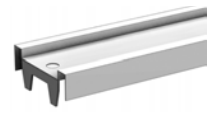

T=TOP RAIL



HS=HALF SPLICER RAIL



SC=SLOTWALL CENTER RAIL

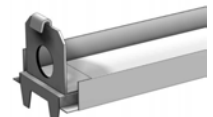

HDB=HEAVY DUTY BOTTOM RAIL

## HARDBOARD BACK SUPPORT CLIP

- 36" - 66"H Uprite requires: one Center Rail and one Support Clip
- 72" - 144"H Uprite requires: two Center Rails, two Support Clips and one Half Splicer

Part #: **HBSC GLV**

1. **Hardboard Back Support Clip: HBSC**
2. **Standard Finish: GLV**



HBSC=HARDBOARD BACK SUPPORT CLIP

### SUFFIX KEY

|                              |                        |
|------------------------------|------------------------|
| T = Top Rail                 | PLT = Platinum Paint   |
| SC = Slotwall Center Rail    | HS = Half Splicer Rail |
| HDB = Heavy Duty Bottom Rail | GLV = Galvanized       |

## WIRE BACK ASSEMBLIES

- Three retainer designs—Single Centered Back, Double Back, and Triple back—allow flexibility of Back panel position to meet your visual merchandising needs
- RBA\_is compatible with Upright heights greater than 30" H
- RBE\_is compatible with Back heights up to 90" H

## WIRE BACK RETAINER ASSEMBLY

- Order Wall or Island Section with no Backs and no Rails
- Order Retainer Back Assembly CAM

### INCLUDES

- **A** Wiregrid Bottom Rail
- **B** Wiregrid Back Retainers
- **C** Backs per your selection
- **D** Top Rail, Splicer Rail (as required)

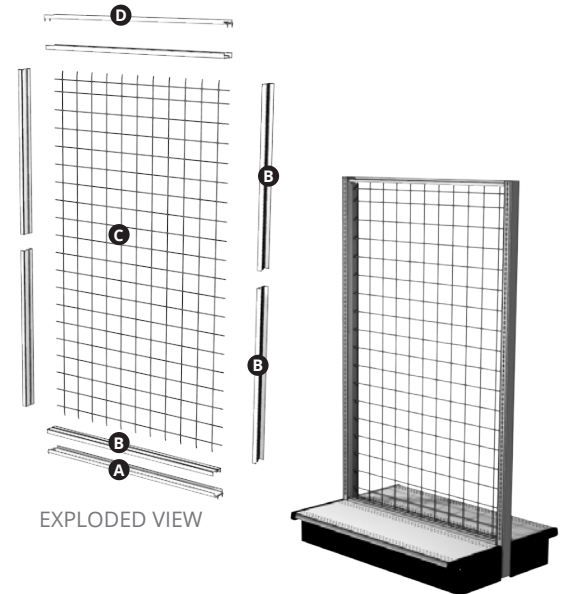

RBA=RETAINER BACK ASSEMBLY

## WIRE BACK RETAINER EXTENSION ASSEMBLY

- Use with Wall or Island Extension sections
- Order Retainer Back Extension CAM to match extension height
- Use with standard BE\_ Backs
- Order Wall or Island sections with no Backs and no Rails
- Order standard BE\_ Backs and Rails to desired height
- Order Retainer Back Extension CAM to match desired Back height

### INCLUDES

- **A** Wire Grid Back Retainers
- **B** Back per your selection
- **C** Top Rail, Splicer Rail (as required)

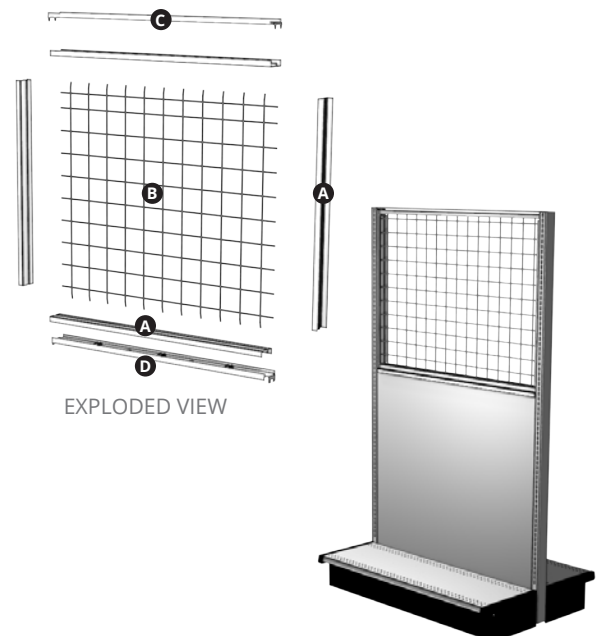

RBE=RETAINER BACK EXTENSION

# WIRE BACK ASSEMBLIES PART NUMBER

|                 |            |          |           |          |           |          |           |            |            |            |            |            |
|-----------------|------------|----------|-----------|----------|-----------|----------|-----------|------------|------------|------------|------------|------------|
| Example Part #: | <b>RBA</b> | <b>4</b> | <b>78</b> | <b>T</b> | <b>SG</b> | <b>M</b> | <b>LG</b> | <b>PLT</b> | <b>PLT</b> | <b>PLT</b> | <b>PLT</b> | <b>PLT</b> |
|                 | 1.         | 2.       | 3.        | 4.       | 5.        | 6.       | 7.        | 8.         | 9.         | 10.        | 11.        | 12.        |

1. **Wire Back Retainer Assembly:** **RBA**, RBE
2. **Section Width:** 2', 30", 3', 4'
3. **Section Height:** 6", 12", 18", 24", 30", 36", 42", 48", 54", 60", 66", 72", **78"**, 84", 90", 96", 108", 120"
4. **Retainer Style:** S, D, **T**
5. **Back A Style:** P, M, ME, P2, M2, WG, **SG**, LG, MG
6. **Back B Style (T Retainer only):** P, **M**, ME, P2, M2
7. **Back C (D and T Retainer only):** WG, SG, **LG**, MG
8. **Rail Finish:** **PLT**, Optional Catalog Colors
9. **Retainer Finish:** **PLT**, Optional Catalog Colors
10. **Back A Finish:** **PLT**, Optional Catalog Colors
11. **Back B Finish:** **PLT**, Optional Catalog Colors
12. **Back C Finish:** **PLT**, Optional Catalog Colors

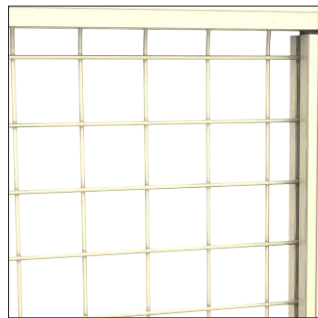

WG=3X3 WIRE GRID

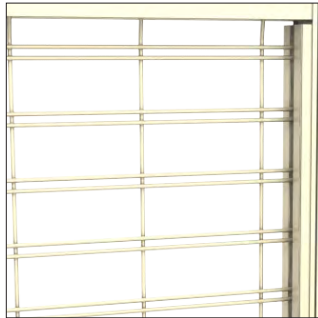

SG= SLOT GRID

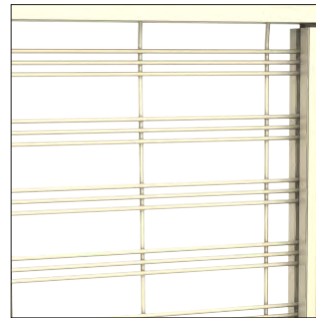

MG= MULTI-GRID



LG= LOUVER GRID

## SUFFIX KEY

|                               |  |
|-------------------------------|--|
| RBA = Retainer Back Assembly  | P2 = Single Pegboard Back, painted two sides |
| RBE = Retainer Back Extension | M2 = Single Marteck Back, painted two sides  |
| S = Single Centered Back      | WG = 3x3 Wire Grid Back                      |
| D = Double Back               | SG = Slot Grid Back                          |
| T = Triple Back               | LG = Louver Grid Back                        |
| P = Pegboard Back             | MG = Multi-Grid Back                         |
| M = Marteck Back              | PLT = Platinum Paint                         |
| ME = Econo Marteck Back       |  |

## WIRE BACK RETAINER EXTENSIONS (WIRE GRID AND HARDBOARD)

- Choose the Back style that meets your visual merchandising needs
- Order RBE\_ 6" shorter than Uprite (Example: U72, order RBE466WG. One-piece backs up to 90"H)

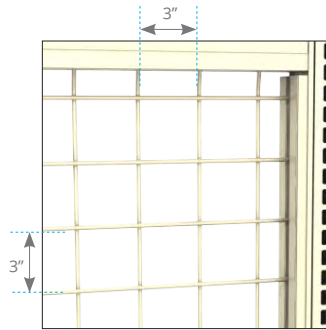

WG=3X3 WIRE GRID  
 • Most Economical  
 • 3x3 Wiregrid Accessories Only

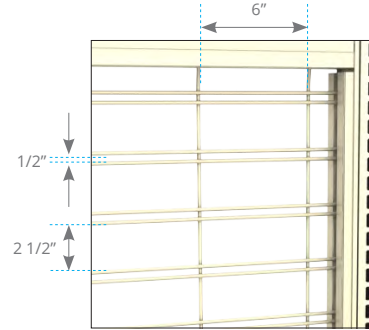

SG=SLOT GRID  
 • Wire Slotwall  
 • Slotwall & 3x3 Accessories

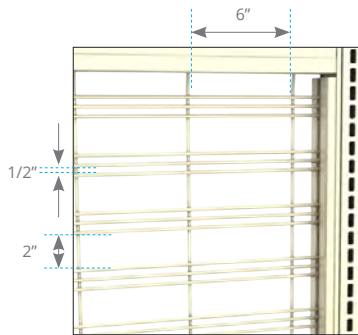

MG=MULTI-GRID  
 • 2 placements every 3"  
 • Peg, Slotwall & 3x3 Accessories

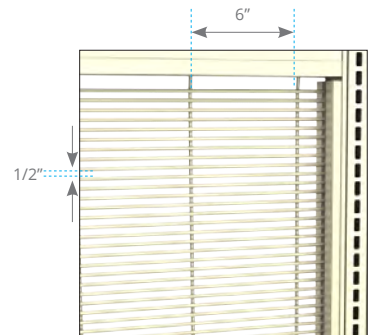

LG=LOUVER GRID  
 • Versatile Grid  
 • Peg & Slotwall Accessories

Example Part #: **RBE 4 54 WG PLT**

1. **Wire Back Retainer Extension: RBE**
2. **Width: 2', 30", 3', 4'**
3. **Height: 06", 12", 18", 24", 30", 36", 42", 48", 54", 60", 66", 72", 78", 84", 90"**
4. **Back Style: WG, SG, LG, MG, P, M, ME, P2, M2**
5. **Standard Finish: PLT, Optional Catalog Colors**

### SUFFIX KEY

WG = 3x3 Wire Grid Back

SG = Slot Grid Back

LG = Louver Grid Back

MG = Multi-Grid Back

P = Pegboard Back

M = Marteck Back

ME = Econo Marteck Back

P2 = Single Pegboard Back, painted two sides

M2 = Single Marteck Back, painted two sides

PLT = Platinum Paint

## WIRE GRID ASSEMBLY BOTTOM RAIL

- Use standard duty for 3x3 Grid and Slot Grid, applications less than 36"W
- Heavy duty option for higher load needs
- Use heavy duty for Louver Grid and Multi-Grid 36"W or 48"W in double or triple back applications

**Example Part # :** BRHD 4 PLT

1. **Wire Grid Assembly Bottom Rail:** BR, BRHD (3' & 4' only)
2. **Width:** 2', 30", 3', 4'
3. **Standard Finish:** PLT, Optional Catalog Colors

BRHD\_ = HEAVY DUTY WIREGRID BOTTOM RAIL

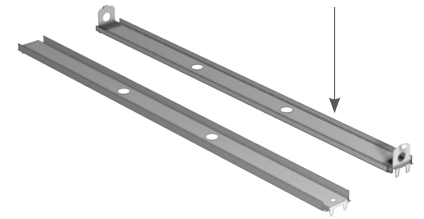

BR\_ = WIREGRID BOTTOM RAIL

## WIRE GRID ASSEMBLY RETAINER

- Wire Backs require perimeter retainers to adapt them for use in standard Lozier Uprites
- For the most efficient length configuration, order lengths per the Wire Back Assembly
- Order two RE\_ to be used in the horizontal application
- Order a minimum two RE\_ to be used in the vertical application
- For sections taller than 54"H (RE\_48) and up to 96", order RU\_upper retainer to correspond to the overall Back height
- For Backs taller than 96"H order one Splicer Rail (R\_S), two horizontal retainers (RE\_), and two vertical retainers (RE\_)

**Example Part # :** RE S 48 PLT

1. **Wire Grid Assembly Retainer:** RE, RU
2. **Retainer Style:** S, D, T
3. **Height:** 06", 12", 18", 24", 30", 36", 42", 48"
4. **Standard Finish:** PLT, Optional Catalog Colors



S=SINGLE BACK RETAINER



D= DOUBLE BACK RETAINER



T=TRIPLE BACK RETAINER

### SUFFIX KEY

|                               |                          |
|-------------------------------|--------------------------|
| BR = Bottom Rail              | RU = Upper Back Retainer |
| BRHD = Heavy Duty Bottom Rail | S = Single Back Retainer |
| PLT = Platinum Paint          | D = Double Back Retainer |
| RE = Extension Back Retainer  | T = Triple Back Retainer |



## OPEN BACKS

- Open Back Spanner replaces Backs and Rails, and fits flush with the top of the Base Deck in both 06 and Low Base
- Shelf Fillers fill the gap between two Shelves mounted across from each other
- Shelf Fillers cannot be used with Shelves in the top Upright slot

### COMPONENTS

- A** Open Back Spanner
- B** Open Back Inside Upright End Trim
- C** Shelf Fillers

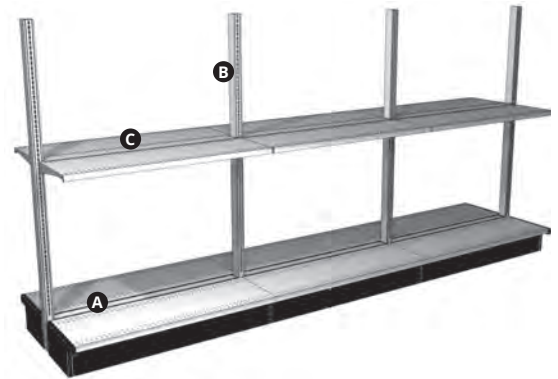

### ORDERING INSTRUCTIONS

- Order Island Section, delete Backs and Rails
- Order Open Back Spanner with Hardware per amount of sections
- Order two Open Back Inside Upright Trim per sections
- Order Shelf Fillers for amount of shelves mounted across from each other

## OPEN BACK SPANNER WITH HARDWARE

| Part #           | Standard Finish         |
|------------------|-------------------------|
| 3'L: <b>OBS3</b> | <b>PLT</b> ,            |
| 4'L: <b>OBS4</b> | Optional Catalog Colors |

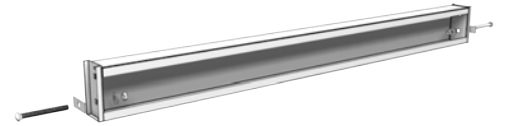

## OPEN BACK INSIDE UPRITE TRIM

Example Part #: **OBT 36 06 PLT**

1. **Open Back Trim: OBT**
2. **Upright Height: 36"**, 42", 48", 54", 60", 66", 72", 84", 90", 96"
3. **Base Height: 06**, LB
4. **Standard Finish: PLT**, Optional Catalog Colors



## OPEN BACK SHELF FILLERS

| Part #           | Standard Finish         |
|------------------|-------------------------|
| 3'L: <b>SF3U</b> | <b>PLT</b> ,            |
| 4'L: <b>SF4U</b> | Optional Catalog Colors |



### SUFFIX KEY

PLT = Platinum Paint

LB = Low Base (6"H)

06 = 06 Base (8"H)

## SD DECK

- Standard Deck style for Island and Wall runs
- Molding accommodates a 1.235" tag
- 1/4" perforations for clip-on accessories
- Can order with Aluminum Tag Moldings installed or can order Molding for Deck separately

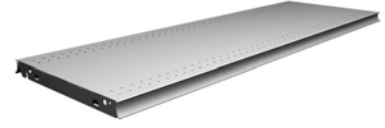

**LBS** 600 lbs evenly distributed (13"-19"D)  
800 lbs evenly distributed (22"-31"D)

**Example Part # :** SD 4 16 N PLT

1. **SD Deck: SD**
2. **Width: 2', 30", 3', 4'**
3. **Base Depth: 13", 16", 19", 22", 25", 28", 31"**
4. **Molding: N, M13S, M13G, M35S, M35G, M55S, M55G**
5. **Standard Finish: PLT, Optional Catalog Colors**

## HDSD DECK

- Heavy Duty Deck holds 50% higher load capacity
- Tag moldings and perforations similar to SD style
- Can order with Aluminum Tag Moldings installed or can order Molding for Deck separately



**LBS** 900 lbs evenly distributed (19"D)  
1,200 lbs evenly distributed (22"-31"D)

**Example Part # :** HDSD 4 19 N PLT

1. **HDSD Deck: HDSD**
2. **Width: 4'**
3. **Base Depth: 19", 22", 25", 28", 31"**
4. **Molding: N, M13S, M13G, M35S, M35G, M55S, M55G**
5. **Standard Finish: PLT, Optional Catalog Colors**

### SUFFIX KEY

|                          |                          |
|--------------------------|--------------------------|
| N = No Molding           | M35G = M35 Gold Molding  |
| M13S = M13 Satin Molding | M55S = M55 Satin Molding |
| M13G = M13 Gold Molding  | M55G = M55 Gold Molding  |
| M35S = M35 Satin Molding | PLT = Platinum Paint     |

## BULLNOSE DECK

- 1 1/4" rounded, front edge
- Two rows of 1/4" holes, 1" on center, accepts most Shelf accessories
- Perforation Options: Unpunched and Standard Perforations
- Installation similar to SD Deck
- Works with standard Base End Trim
- Available with deflection-resistant reinforced front edge (RE)

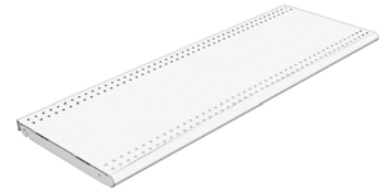

*lbs evenly distributed*

| DEPTH | WIDTH |     |     |     |
|-------|-------|-----|-----|-----|
|       | 24"   | 30" | 36" | 48" |
| 13"   | 200   | 250 | 300 | 400 |
| 16"   | 200   | 250 | 300 | 400 |
| 19"   | 200   | 250 | 300 | 400 |
| 22"   | 300   | 375 | 450 | 600 |
| 25"   | 300   | 375 | 450 | 600 |
| 28"   | 300   | 375 | 450 | 600 |
| 31"   | 300   | 375 | 450 | 600 |

| Example Part # : | BND | 4  | 16 | UP | N  | PLT |
|------------------|-----|----|----|----|----|-----|
|                  | 1.  | 2. | 3. | 4. | 5. | 6.  |

1. **Bullnose Deck:** BND, BNDRE
2. **Width:** 2', 30", 3', 4'
3. **Base Depth:** 13", 16", 19", 22", 25", 28", 31"
4. **Perforation Option:** UP, Omit for punched
5. **Molding:** N
6. **Standard Finish:** PLT, Optional Catalog Colors

## RADIUS DECKS

- Use with Radius Shelves to create focal point mid-run or on End Displays
- Outward Radius Front projects 3", Inward Radius Front recesses 2"
- 1.235"H Tag Molding and unpunched top
- Compatible with Standard Base Fronts and Radius Base Fronts

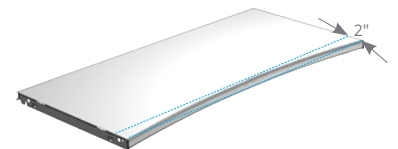

RDI\_= INWARD RADIUS DECK

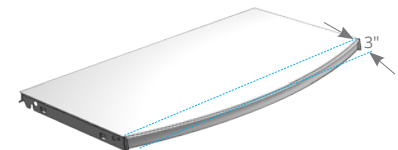

RDO\_=OUTWARD RADIUS DECK



*95 lbs/sq ft up to 600 lbs evenly distributed*

| Example Part # : | RDI | 4  | 16 | 02 | N  | PLT |
|------------------|-----|----|----|----|----|-----|
|                  | 1.  | 2. | 3. | 4. | 5. | 6.  |

1. **Radius Deck:** RDI, RDO
2. **Width:** 2', 30", 3', 4'
3. **Bracket Depth:** 13", 16", 19", 22", 25", 28", 31"
4. **Projection:** 02" (Inward Only), 03" (Outward Only)
5. **Molding:** N
6. **Standard Finish:** PLT, Optional Catalog Colors

### SUFFIX KEY

|                                  |                            |
|----------------------------------|----------------------------|
| BND = Bullnose Deck              | RDO = Radius Deck, Outward |
| BNDRE = Reinforced Bullnose Deck | UP = Unpunched             |
| RDI = Radius Deck, Inward        | PLT = Platinum Paint       |

## RADIUS CLOSED BASE FRONTS

- Outward Radius Base Front projects 3", Inward Radius Base Front recesses 2"
- Use with Radius Deck to complete the curved look

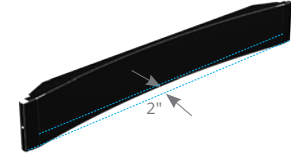

ICF\_=INWARD RADIUS CLOSED BASE FRONT

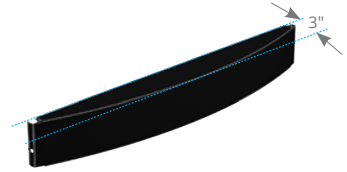

OCF\_=OUTWARD RADIUS CLOSED BASE FRONT

Example Part # : **OCF 4 03 06 CHR**

1. **Radius Closed Base Front:** ICF, **OCF**
2. **Width:** 2', 30", 3', 4'
3. **Projection:** 02" (Inward Only), **03"** (Outward Only)
4. **Base Height:** **06**, LB
5. **Standard Finish:** **CHR**

## BOOK DECK

- Designed to fit on a Low Base Island or Wall section

Example Part # : **BKD 4 12 PLT**

1. **Book Deck:** **BKD**
2. **Width:** 3', 4'
3. **Depth:** 9", 12"
4. **Standard Finish:** **PLT**, Optional Catalog Colors

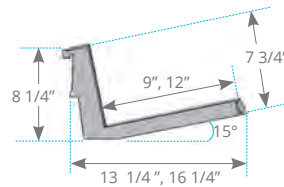

150 lbs evenly distributed



To order correct configurations for 9"D and 12"D Book Decks, order Low Base Island or Wall Sections and Ends with either 13"D Base Decks for 9"D Book Decks or 16"D Base Decks for 12"D Book Decks. Then delete all CBF\_LB, BET\_LB, and Base Decks (SD\_N) and add the same quantities of CBF\_06, BET\_06, and Book Decks.

### SUFFIX KEY

|  |                            |
|--|----------------------------|
| PLT = Platinum Paint                   | 06 = 06 Base (8"H)         |
| ICF = Inward Radius Closed Base Front  | LB = Low Base (6"H)        |
| OCF = Outward Radius Closed Base Front | CHR = Charcoal Black Paint |